

JULY TERM, 2013

COUNTY OF MONTAGUE

REGULAR SESSION

BE IT REMEMBERED, That on this 22nd day of July 2013, Commissioners Court of Montague County, Texas met at a regular meeting with the following present:

Tommie Sappington	County Judge	Herman Conway	Commissioner Precinct 1
James Gamblin	Commissioner Precinct 2	Mark Murphy	Commissioner Precinct 3
Bob Langford	Commissioner Precinct 4	Glenda Henson	County Clerk

The meeting was called to order by Judge Sappington at 9:00 a.m.
Pledge of Allegiance and Pledge to the Texas Flag was led by Judge Sappington.

#13-245- APPROVAL OF MINUTES

Motion by Commissioner Gamblin and seconded by Commissioner Murphey to approve minutes for the July 8th, 2013 meeting.

All Voted For
Motion Carried

#13-246-APPROVE MONTHLY REPORTS

Motion by Commissioner Langford and seconded by Commissioner Murphey to approve the monthly reports: No monthly reports. Reports Audited: Sheriff Fees, County Attorney, JP 1, JP 2, County Clerk, and District Clerk.

All Voted For
Motion Carried

#13-247-PAY CLAIMS

Motion by Commissioner Langford and seconded by Commissioner Gamblin to pay the claims as presented in court.

All Voted For
Motion Carried

#13-248-PRESENTATION OF THE DISTINGUISHED SERVICE AWARD CERTIFICATE TO THE MONTAGUE COUNTY HISTORICAL

County Judge Tommie Sappington presented the Montague County Historical Commission the Distinguished Service Award Certificate.

No Action Taken

✓ #13-249-CLINT BROWN AND LORRA LIERLY FROM THE MONTAGUE COUNTY CHILD WELFARE BOARD TO UPDATE COMMISSIONERS COURT

The Child Welfare Board updated Commissioner Court about the County being ranked high in the State for Child Abuse cases.

No Action Taken

#13-250-DISCUSS AND CONSIDER APPOINTING ELECTION JUDGES FOR THE 2013-2014 YEAR

AND IT IS SO ORDERED. WITNESS OUR HANDS, THIS THE 22nd DAY OF July, 2013

Tommie Sappington
 COUNTY JUDGE

Herman Conway
 COMMISSIONER, PRECINCT #1

Mark Murphy
 COMMISSIONER, PRECINCT #3

Glenda Henson
 CLERK, COUNTY COURT AND EX-OFFICIO
 CLERK OF THE COMMISSIONER'S COURT, MONTAGUE COUNTY, TEXAS.

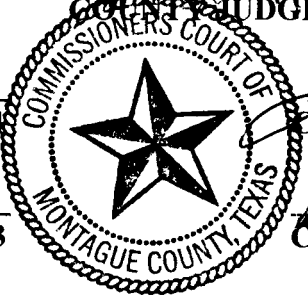

[Signature]
 COMMISSIONER, PRECINCT #2

[Signature]
 COMMISSIONER, PRECINCT #4

THE STATE OF TEXAS

IN THE COMMISSIONERS COURT

JULY TERM, 2013

COUNTY OF MONTAGUE

REGULAR SESSION

BE IT REMEMBERED, That on this 22nd day of July 2013, Commissioners Court of Montague County, Texas met at a regular meeting with the following present:

Tommie Sappington	County Judge	Herman Conway	Commissioner Precinct 1
James Gamblin	Commissioner Precinct 2	Mark Murphy	Commissioner Precinct 3
Bob Langford	Commissioner Precinct 4	Glenda Henson	County Clerk

Motion by Commissioner Langford and seconded by Commissioner Murphey to appoint 2013-2014 Election Judges for the County as presented by Election Administrator, Brandi Shipman.

All Voted For
Motion Carried

#13-251-DISCUSS AND CONSIDER BUDGET ADJUSTMENTS FROM UNANTICIPATED REVENUE OFR PCT # 3

Motion by Commissioner Murphey and seconded by Commissioner Gamblin to transfer \$9,795.00 from Pct # 3 unanticipated revenue line item # 999 to Pct # 3 building line item # 572 as a budget adjustment.

All Voted For
Motion Carried

#13-252-DISCUSS AND CONSIDER BUDGET ADJUSTMENTS FROM UNANTICIPATED REVENUE FOR PCT # 2

Motion by Commissioner Gamblin and seconded by Commissioner Langford to transfer \$3,600.00 (received from donations Silver Lakes) from Pct # 2 unanticipated revenue to Pct # 2 pavement line item.

All Voted For
Motion Carried

#13-253-DISCUSS AND CONSIDER CLEARING FENCE LINE ON KINGERY RANCH PROPERTY ON ROYAL LANE IN PCT # 1

Motion by Commissioner Conway and seconded by Commissioner Langford to approve clearing the fence line on Kingery Ranch property on Royal Lane in Pct # 1.

All Voted For
Motion Carried

#13-254-DISCUSS AND CONSIDER CLEARING FENCE LINE ON JOE STOUT PROPERTY ON ROCK SPRINGS SCHOOL ROAD IN PCT # 3

Motion by Commissioner Murphey and seconded by Commissioner Gamblin to approve clearing the fence line on Joe Stout property on Rock Springs School Road in Pct # 3.

All Voted For
Motion Carried

AND IT IS SO ORDERED.WITNESS OUR HANDS, THIS THE 22nd DAY OF July, 2013

Tommie Sappington

 COUNTY JUDGE

Herman Conway

 COMMISSIONER, PRECINCT #1

James Gamblin

 COMMISSIONER, PRECINCT #2

Mark Murphy

 COMMISSIONER, PRECINCT #3

Bob Langford

 COMMISSIONER, PRECINCT #4



ATTEST: *Glenda Henson*

 CLERK, COUNTY COURT AND EX-OFFICIO
 CLERK OF THE COMMISSIONER'S COURT, MONTAGUE COUNTY, TEXAS.

JULY TERM, 2013

COUNTY OF MONTAGUE

REGULAR SESSION

BE IT REMEMBERED, That on this 22nd day of July 2013, Commissioners Court of Montague County, Texas met at a regular meeting with the following present:

Tommie Sappington	County Judge	Herman Conway	Commissioner Precinct 1
James Gamblin	Commissioner Precinct 2	Mark Murphy	Commissioner Precinct 3
Bob Langford	Commissioner Precinct 4	Glenda Henson	County Clerk

#13-255-DISCUSS CONSIDER APPROVING REQUEST OF COUNTY AUDITOR, JENNIFER ESSARY TO REMOVE ITEMS FROM INVENTORY

Motion by Commissioner Langford and seconded by Commissioner Gamblin to approve the request from Jennifer Essary, County Auditor, to remove items from inventory.

All Voted For
Motion Carried

#13-256-DISCUSS AND CONSIDER HB 1513 RELATING TO INCREASES IN THE RECORDS ARCHIVE FEES AND THE RECORDS MANAGEMENT/PRESERVATION FEES CHARGED BY DISTRICT AND COUNTY CLERKS

Motion by Commissioner Murphey and seconded by Commissioner Gamblin to approve HB 1513 which increases the County and District Clerk Records Management and Archive Fees from \$5 to \$10.

All Voted For
Motion Carried

#13-257-DISCUSS AND CONSIDER REQUEST BY TEXAS DEPARTMENT OF STATE HEALTH SERVICES TO CONSOLIDATE LOCAL REGISTRARS AND IF SO GRANTED SIGN RESOLUTION

Motion by Commissioner Langford and seconded by Commissioner Murphey to approve the request by Texas Department of State Health Services to consolidate the previous local registrars from the City of Bowie and the City of Nocona. Thus having only one Local Registrar for the County which will be the County Clerk.

All Voted For
Motion Carried

#13-258-DISCUSS AND CONSIDER REQUEST OF NORTEX REGIONAL PLANNING COMMISSION TO APPROVE AND AUTHORIZE JUDGE SAPPINGTON TO SIGN THE RESOLUTION OF MONTAGUE COUNTY AUTHORIZING AND APPROVING THE APPOINTMENT AND REAPPOINTMENT OF INDIVIDUALS TO THE BOARD OF DIRECTORS OF THE NORTEX HOUSING FINANCE CORPORATION

Motion by Judge Sappington and seconded by Commissioner Langford to give Judge Sappington authority to sign the resolution approving the appointment of individuals to the Board of Directors of the Nortex Housing Finance Corporation.

All Voted For
Motion Carried

AND IT IS SO ORDERED. WITNESS OUR HANDS, THIS THE 22nd DAY OF July, 2013

Tommie Sappington
 COUNTY JUDGE

Herman Conway
 COMMISSIONER, PRECINCT #1

James Gamblin
 COMMISSIONER, PRECINCT #2

Mark Murphy
 COMMISSIONER, PRECINCT #3

Bob Langford
 COMMISSIONER, PRECINCT #4

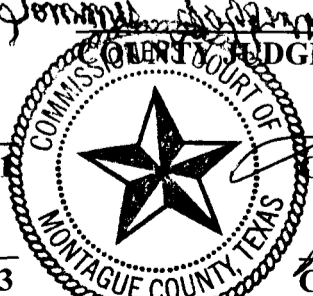

ATTEST: *Glenda Henson* CLERK, COUNTY COURT AND EX-OFFICIO CLERK OF THE COMMISSIONER'S COURT, MONTAGUE COUNTY, TEXAS.

THE STATE OF TEXAS

IN THE COMMISSIONERS COURT

JULY TERM, 2013

COUNTY OF MONTAGUE

REGULAR SESSION

BE IT REMEMBERED, That on this 22nd day of July 2013, Commissioners Court of Montague County, Texas met at a regular meeting with the following present:

Tommie Sappington	County Judge	Herman Conway	Commissioner Precinct 1
James Gamblin	Commissioner Precinct 2	Mark Murphy	Commissioner Precinct 3
Bob Langford	Commissioner Precinct 4	Glenda Henson	County Clerk

#13-259-DISCUSS AND CONSIDER REQUEST OF PIONEER NATURAL RESOURCES USA, INC. TO APPROVE ROAD CROSSINGS ON DITTO ROAD IN PCT # 1

Motion by Commissioner Conway and seconded by Commissioner Murphey to allow Pioneer to cross Ditto Road in Pct # 1.

All Voted For
Motion Carried

#13-260-DISCUSS AND CONSIDER REQUEST OF PIONEER NATURAL RESOURCES USA INC. TO APPROVE ROAD CROSSINGS ON DOG KENNEL ROAD, ORCHARD ROAD AND SMYRNA ROAD IN PCT # 2.

Motion by Commissioner Gamblin and seconded by Commissioner Murphey to allow Pioneer to cross Dog Kennel Road in Pct. # 2 Orchard & Smyrna RD.

All Voted For
Motion Carried

#13-261-DISCUSS AND CONSIDER REQUEST OF EOG RESOURCES, INC., TO APPROVE TEMPORARY ROAD CROSSING ON APPLGATE ROAD IN PCT # 1

Motion by Judge Sappington and seconded by Commissioner Langford to table this item.

All Voted For
Motion Tabled

#13-262-DISCUSS AND CONSIDER REQUEST OF EOG RESOURCES INC., TO APPROVE TEMPORARY FRAC LINES ON ALLEN ROAD IN PCT # 1

Motion by Commissioner Conway and seconded by Commissioner Gamblin to allow EOG to lay temporary frac lines on Allen Road in Pct # 1.

All Voted For
Motion Carried

#13-263-DISCUSS AND CONSIDER REQUEST OF EOG RESOURCES, INC. TO APPROVE ROAD CROSSING ON EAST RC ROAD IN PCT # 2

Motion by Commissioner Gamblin and seconded by Commissioner Murphey to allow EOG to cross East RC Road in Pct # 2.

All Voted For
Motion Carried

#13-264-DISCUSS AND CONSIDER REQUEST OF EOG RESOURCE4S, INC. TO APPROVE ROAD CROSSING ON PAYNE ROAD IN PCT #4.

AND IT IS SO ORDERED. WITNESS OUR HANDS, THIS THE 22nd DAY OF July, 2013

Tommie Sappington
 COUNTY JUDGE

Herman Conway
 COMMISSIONER, PRECINCT #1

Mark Murphy
 COMMISSIONER, PRECINCT #3

Tommy Miller
 COMMISSIONER, PRECINCT #2

Glenda Henson
 ATTEST: CLERK, COUNTY COURT AND EX-OFFICIO CLERK OF THE COMMISSIONER'S COURT, MONTAGUE COUNTY, TEXAS.

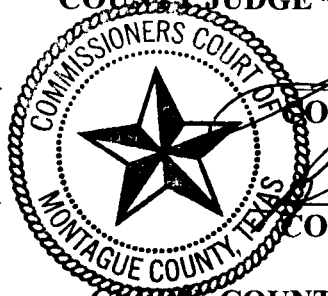

JULY TERM, 2013

COUNTY OF MONTAGUE

REGULAR SESSION

BE IT REMEMBERED, That on this 22nd day of July 2013, Commissioners Court of Montague County, Texas met at a regular meeting with the following present:

Tommie Sappington	County Judge	Herman Conway	Commissioner Precinct 1
James Gamblin	Commissioner Precinct 2	Mark Murphy	Commissioner Precinct 3
Bob Langford	Commissioner Precinct 4	Glenda Henson	County Clerk

Motion by Commissioner Langford and seconded by Commissioner Murphey to allow EOG to cross Payne Road in Pct. # 4.

All Voted For
Motion Carried

Meeting Adjourned

AND IT IS SO ORDERED. WITNESS OUR HANDS, THIS THE 22nd DAY OF July, 2013

Herman Conway
COMMISSIONER, PRECINCT #1

Mark Murphy
COMMISSIONER, PRECINCT #3

ATTEST: Glenda Henson
CLERK, COUNTY COURT AND EX-OFFICIO
CLERK OF THE COMMISSIONER'S COURT, MONTAGUE COUNTY, TEXAS.

Dominic Sappington
COUNTY JUDGE

James Gamblin
COMMISSIONER, PRECINCT #2

Bob Langford
COMMISSIONER, PRECINCT #4



July 22, 2013

Reports

Report Audits

Sheriff Fees
County Attorney Fees
JP 1 Fees
JP 2 Fees
County Clerk Fees
District Clerk Fees

Jennifer Essary

Montague County Auditor
P.O. Box 56-Montague, Texas 76251
Phone (940)-894-2131-Fax (940)-894-3110

July 8, 2013

Paul Cunningham
Sheriff
and
Montague County
Commissioners Court

Dear Gentlemen,

The Sheriff report for May 2013 was audited on July 8, 2013. The report listed the total collections for the month. A copy of the receipt's journal was attached for reference. The report was filed June 5, 2013.

The total money collected for the month and deposited with the County Treasurer were \$5,773.36. The following were collected:

Cash Bonds	\$ 3,700.00
Sheriff Fees	\$ 100.00
Constable Fees	\$ 100.00
Offense Report Fee	\$ 0.00
Ins & Outs	\$ 808.36
Bail Bond Fee	\$ 1,065.00
Miscellaneous	\$ 0.00

The Sheriff and Constable Fees for May 2013 was up by \$90.00 from April 2013 and down by \$25.00 from May 2012.

The work papers for the Sheriff monthly report audit are on file in the County Auditor's office.

Respectfully submitted,



Jennifer Essary

cc: Jack McGaughey
97th Judicial District Judge

Jennifer Essary

Montague County Auditor
P.O. Box 56 Montague, Texas 76251
Phone (940)-894-2131-Fax (940)-894-3110

July 9, 2013

Clay Riddle
County Attorney
AND
Montague County
Commissioners Court

Dear Gentlemen:

The County Attorney Hot Check Fund Report for May was audited on July 9, 2013. The report listed the total restitution, county attorney fees, victim fees, and administration fees collected for the month. The report was filed in the County Auditor's office on June 3, 2013 and was signed by the elected official.

The May report totaled \$1,866.70. The following were collected for the month by the County Attorney's office:

Administration Fees	\$22.06
Hot Check Fees	\$456.84
Victim Fees	\$168.60
Restitution	\$1,219.20

The County Attorney Hot Check fees for May were up \$129.11 and the Administration fees were down \$7.94 from last month. The County Attorney Hot Check fees for May 2013 were down \$658.85 and Administration fees were down \$32.72 from fiscal year 2012 at this time.

The County Treasurer's receipt was agreed to the report. The receipt properly deposited the collections into the appropriate funds according to the report.

The work papers for the County Attorney Hot Check Fund report are on file in the County Auditor's office.

Respectfully submitted,



Jennifer Essary,
County Auditor

cc: Jack McGaughey
97th Judicial District Judge

Jennifer Essary

Montague County Auditor
P.O. Box 56 Montague, Texas 76251
Phone (940)-894-6090

July 16, 2013

David Allen
Justice of the Peace #1
and
Montague County
Commissioners Court

Dear Gentlemen,

The Justice of the Peace, Precinct #1 report for June was audited July 16, 2013. The report listed the fees and fines collected for the month. The report was filed on July 8, 2013 and signed by the elected official.

The monthly report totaled \$16,919.10. The following were collected for the month:

General Fees	\$ 11,502.50
Courthouse Security	\$ 251.00
Tech Fund Fees	\$ 252.00
State Fees	\$ 4,913.60

The June 2013 report was up by \$441.10 from May 2013. General Fees were up by \$636.45, Courthouse Security fees were up by \$7.00, Tech Fees were up by \$10.00 and State Fees down by \$212.35 from last month. The June 2013 report was up by \$9,298.60 from June 2012. General Fees were up \$7,327.25, Courthouse Security up by \$100.00, Tech Fees were up by \$104.00 and State Fees up by \$1,767.35 from last year.

The Treasurer's receipt was agreed to the monthly report. The receipt properly deposited the collections in the appropriate funds according to the report.

The work papers for the Justice of the Peace, Precinct #1 monthly report audit are on file in the County Auditor's office.

Respectfully submitted,



Jennifer Essary

cc: Jack McGaughey
97th District Judge

Jennifer Essary

Montague County Auditor
P.O. Box 56-Montague, Texas 76251
Phone (940) 894-6090

July 16, 2013

Paul Cunningham
Sheriff
and
Montague County
Commissioners Court

Dear Gentlemen,

The Sheriff report for June 2013 was audited on July 16, 2013. The report listed the total collections for the month. A copy of the receipt's journal was attached for reference. The report was filed July 8, 2013.

The total money collected for the month and deposited with the County Treasurer were \$6,912.00. The following were collected:

Cash Bonds	\$ 5,073.00
Sheriff Fees	\$ 0.00
Constable Fees	\$ 100.00
Offense Report Fee	\$ 0.00
Ins & Outs	\$ 689.00
Bail Bond Fee	\$ 1,050.00
Miscellaneous	\$ 0.00

The Sheriff and Constable Fees for June 2013 was down by \$115.00 from May 2013 and down by \$933.00 from June 2012.

The work papers for the Sheriff monthly report audit are on file in the County Auditor's office.

Respectfully submitted,



Jennifer Essary

cc: Jack McGaughey
97th Judicial District Judge

Jennifer Essary

Montague County Auditor
P.O. Box 56 Montague, Texas 76251
Phone (940) 894-6090

July 16, 2013

Karen Reynolds
Justice of the Peace #2
and
Montague County
Commissioners Court

Dear Gentlemen,

The Justice of the Peace, Precinct #2 report was audited July 16, 2013. The report listed the fees and fines collected for the month of June. The report was filed on July 12, 2013 and signed by the elected official.

The monthly report totaled \$33,806.30. The following were collected for the month.

General Fees	\$22,628.76
Courthouse Security	\$ 485.75
Tech Fund Fees	\$ 488.82
State Fees	\$ 10,202.97

The June 2013 report was down by \$12,937.90 from May 2013. General Fees were down by \$6,938.25, Courthouse Security was down by \$254.74, Tech Fees were down by \$255.76 and State Fees were down by \$5,489.15 from last month. The June 2013 report was down by \$1,539.95 from June 2012. General Fees were down by \$1,703.14, Courthouse Security down by \$27.04, Tech Fees down by \$20.99, and State Fees up by \$211.22 from last year.

The Treasurer's receipt was agreed to the monthly report. The receipt properly deposited the collections in the appropriate funds according to the report.

The work papers for the Justice of the Peace, Precinct #2 monthly report audit are on file in the County Auditor's office.

Respectfully submitted,



Jennifer Essary

cc: Jack McGaughey
97th District Judge

Jennifer Essary

Montague County Auditor
P.O. Box 56-Montague, Texas 76251
Phone (940)-894-2131-Fax (940)-894-3110

July 16, 2013

Lesia Darden
District Clerk
and
Montague County
Commissioners Court

Dear Ladies and Gentlemen,

The District Clerk report for June 2013 was audited on July 16, 2013. The report listed the fees and fines collected for the month. The report was filed July 12, 2013 and signed by the elected official.

The monthly report totaled \$16,523.79. The following were collected and deposited into each fund:

General Fees	\$ 11,946.79
Courthouse Security	\$ 148.00
Record Management & Tech	\$ 837.50
State Fees	\$ 3,591.50

The June 2013 report was down by \$9,740.55 from the May 2013 report. General Fees were down by \$6,348.90, Courthouse Security went down by \$122.00, Record Management and Technology Fees went down by \$571.44, and State Fees went down \$2,698.21 from last month. The June 2013 report was down by \$7,183.41 from June 2012. General Fees were down by \$6,736.41, Courthouse Security was down by \$3.00, Record Management and Technology Fees went down by \$40.50, and State Fees went down by \$403.50 from last year.

The Treasurer's receipt was agreed to the monthly report and the collections were deposited in the appropriate state and county funds according to the report.

The work papers for the District Clerk monthly report audit are on file in the County Auditor's office.

Respectfully submitted,

Jennifer Essary

cc: Jack McGaughey
97th Judicial District Judge

Jennifer Essary

Montague County Auditor
P.O. Box 56 Montague, Texas 76251
Phone (940)-894-2131-Fax (940)-894-3110

July 16, 2013

Glenda Henson
County Clerk
and
Montague County
Commissioners Court

Dear Ladies and Gentlemen,

The County Clerk report for June 2013 was audited on July 16, 2013. The report listed the fees and fines collected for the month. The report was filed July 10, 2013 and signed by the elected official.

The report totaled \$52,413.25. The following were collected and deposited into each fund:

General Fees	\$ 32,468.19
Road & Bridge Fines	\$ 6,708.00
Courthouse Security	\$ 1,318.00
Record Management & Tech	\$ 6,766.00
State Fees	\$ 5,153.06

The June 2013 report was down by \$2,803.00 from May 2013. General Fees were down by \$6,996.05, R&B fines were up by \$3,520.00, Courthouse Security was down by \$241.00, Record Management and Tech fees were down by \$1,092.00, and State Fees were up by \$2,006.05 from last month. The June 2013 report was down by \$13,464.00 from June 2012. General Fees were down by \$6,032.50, R&B fines were down by \$8,609.00, Courthouse Security down by \$10.00, Record Management and Tech Fees down by \$186.00, and State Fees up by \$1,373.50 from last year.

The Treasurer's receipt was compared to the monthly report and the collections were deposited in the appropriate funds according to the report.

The work papers for the County Clerk monthly report audit are on file in the County Auditor's office.

Respectfully submitted,



Jennifer Essary

cc: Jack McGaughey
97th Judicial District Judge

JUDGES FOR COUNTY ELECTIONS
One year term beginning on August 1, 2013
 Appointed by Commissioner's Court (revised 7-22-13)

Precinct # and Location	Voting Precinct Judge/ Republican Judge	Alternate Judge/ Democrat Judge
Montague County Courthouse Early Voting Ballot Board & Signature Verification	Doris McGuffey Jennifer Essary PO Box 1317 Bowie, TX 76230 940/872-3644	LaVonda Langford
2-River of Life Church	Ron Abbott 1510 FM 1816 Bowie, TX 76230 940-841-1405	Jo Kleinhans 294 Kleinhans Bowie, TX 76230 940-872-4208
3-City of Bowie Comm. Room		
4-Southside Baptist Church	Karen Burgess 171 Williamson Rd. Bowie, TX 76230 940-872-1279 972-529-7808	Sylvia Campbell 847 CountryClubRd Bowie, TX 76230 940-872-1948
5-Bowie Bible Baptist Church	Barbara Wunningham 607 E Nelson St. Bowie, TX 76230 940/872-2740	Nan Park PO Box 84 Bowie, TX 76230 940/872-1687
6-Bowie VFW	Paula Brooks 2652 FM 3043 Bowie, TX 76230 940/872-6861	Rebecca Sikes 4 Creekwood St. Bowie, TX 76230 940/872-3586
7-Forestburg Community Center	Amber Choate 797 FM 1749 Forestburg, TX 76239 940-736-9748	Ronald Miner PO Box 411 Forestburg, TX 76239 940-964-2410

8-Sunset Fire Hall	Danny Russell 219 Spur 511 Sunset, TX 76270 940/845-3721	Tina Malley 230 Proctor Lane Sunset, Texas 76270 940-366-1105
9-Tales n Trails Museum	Pat Keck 6938 FM 1956 Nocona, TX 76255 940-987-3460	Suzanne Murray 233 Hillcrest Nocona, TX 76255 940-284-2931
10-Nocona ISD Comm. Room	Margaret Woodyard 400 W. Bluemound Nocona, TX 76255 940/825-6210	Virginia Fenner 4481 FM 1759 Nocona, TX 762553 940/825-
11-Nocona Comm. Ctr.	Betty Brasier 213 Carolyn Rd. Nocona, TX 76255 940/825-4447	Sandra Wilson 600 Main Nocona, TX 76255 940/825-5097
12-Ringgold Elementary	Max Brown 17702 Crenshaw Rd Ringgold, TX 76261 940/934-6325	Heidi Allen 420 Cook RD. Ringgold, TX 76261 940/642-8290
13-St. Jo Civic	Sam Weller 3386 FM 1815 Nocona, TX 76255 940/987-3047	Dorothy Moore PO Box 290 Saint Jo, TX 76265 940/995-2744
14-Valley View Baptist Church	Diane Carpenter 7886 FM 2953 Nocona, TX 76255 940/825-3786	Christy Tompkins 163 Green ST. Nocona, TX 76255 940-233-9094
15-Montague County Court	Jim Weaver PO Box 326 Montague, TX 76251 940/894-6887	Marilyn Vermeland 3947 FM 1806 Nocona, TX 76255 940/894-2172

16-Phoenix Textile Co.

**James Kittrell
PO Box 188
Montague, TX 76251
940/894-6630
940/366-5388**

**Frances Reaves
212 Reaves Rd.
Bowie, TX 76230
940/872-3483**

Resolution Committee

**Mari-Kathryn Braswell
PO Box 28
Forestburg, TX 76239
214-649-7590**

**Angie Odom
400 Lindsey, Ste D
Bowie, Texas 76230
940/872-7095**

Election Administrator: Brandi Shipman

County Election Board: Judge Tommie Sappington; Glenda Henson, County Clerk; Syd Nowell, Tax/Assr; Mari-Kathryn Braswell, Republican Party Chairman; and Angie Odom, Democratic Party Chairman.

**Central Counting Station Manager: Brandi Shipman
Tabulation Supervisor: Kelli Faught**

EV Montague County Courthouse 1st Floor

- 1. Becky O'Neal, 734 N. McCool Rd. Nocona, Tx 972-741-0769**
- 2. Frances Reaves, alternate**

EV-1 Branch Bowie Legend Bank

- 1. Nan Park**
- 2. Barbara Winningham, alternate**

EV-2 Branch Nocona Comm. Ctr.

- 1. Pat Keck**
- 2. Suzanne Murray, alternate**

TEXAS HISTORICAL COMMISSION

PRESENTS THIS

2012

DISTINGUISHED SERVICE AWARD

TO

MONTAGUE COUNTY HISTORICAL COMMISSION

IN RECOGNITION OF ITS ACTIVE
AND WELL-BALANCED PRESERVATION PROGRAM

Mark Wolfe
EXECUTIVE DIRECTOR
6/20/13
DATE

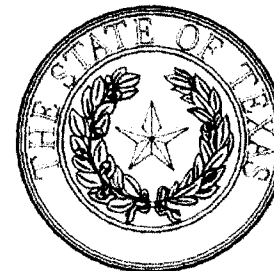

TEXAS HISTORICAL COMMISSION
real places telling real stories

Items Requested to be Removed from Inventory

Tag #	Dept	Description	Date of Purchase	Recorded Value	Reason for Removal			
							400	52170.5
3055	Co Clerk	Software	Mar-06		Not an asset	14814.28	420	15000
3276	Co Judge	Software	Nov-07		Not an asset	2000	1136.46	21474.55 k
2743	Dst Court	Full Court Software	Dec-04		Not an asset	20464.3	2090.01	12000 k
2745	Dst Court	Software	Dec-04		Not an asset	1464.7	3005.31	9795 k
3182	Dst Court	Software License	May-07		Not an asset	4278.42	4084.8	24230.42 k
2765	Dst Court	Intel Pentium 4 Computer	Apr-05		Broke	1694	3112.43	29900 k
2662	JP 1	Docket Program/Incode	Apr-04		Not an asset/User Fee	5897.92	4236.02	40479 k
2797	JP 1	Dell Computer	Jun-05		Broke	6400	6181.72	1285.33 k
3162	JP 1	Incode Software	Jun-06		Not an asset/User Fee	22808.3	3813.24	1000 k
2661	JP 2	Docket Program/Incode	Apr-04		Not an asset/User Fee	945	2355.38	
2611	JP 2	Computer System	Feb-03		Broke	4162.04	3326.29	
2612	JP2	Computer System	Feb-03		Broke	6520	2832.97	
2799	JP 2	Dell Computer	Jun-05		Broke	8000	2911.58	
2846	JP 2	Incode Software	Aug-05		Not an asset/User Fee	32365.88	6634.34	
3260	JP 2	Canon Copier	Apr-08		Broke	2650	369.09	
2310	Co Att	Portable Car Video System	Sep-01		Broke	800	3717.06	
2501	Co Att	Dell Computer/Monitor	Feb-03		Broke	3750	508.74	
3279	Co Att	JP Compaq Business Notebook	Jan-08		Missing	6809.4	1118.95	
2410	Co Att	4 Drawer File Cabinet	Jun-02		correction	2291.88	1861.46	
2402	Dist Att	Sharp Digital Copier	Mar-02		Traded in	714	2313.11	
3198	Dist Att	Software License	Sep-07		Not an asset/User Fee	4501.23	1894.41	
3112	TAC	Soutwest Data Software	Oct-03		Not an asset/User Fee	1485.12	1601.64	
3306	TAC	Dell Optiplex 740	Aug-08		No longer in use	249.99	3536.52	
3307	TAC	Dell Optiplex 740	Aug-08		No longer in use	3634.05	5787.87	
3308	TAC	Dell Optiplex 740	Aug-08		No longer in use		5426.02	
2169	Juv Prob	2005 Ford Crown Vic	May-00		Traded in		3614.53	
2545	Sheriff	Computer	Jul-03		Broke		1919.96	
1083	R&B 3	1989 Chevy Pickup	Aug-89		FA Error		2629.74	
1883	R&B 3	1981 Tank Trailer	Sep-97		Sold		2355.53	
3263	R&B 3	1998 Ford Pickup	Mar-08		Sold		4637.52	
3264	R&B 3	1998 Ford Pickup	Apr-08		FA Error		1727.49	
772	R&B 3	Truck Shed 18x75	Jan-78		Requested		2866.41	
773	R&B 3	Welding Shop 12x16	Jan-78		Requested		2407.69	
774	R&B 3	Built Shed 24x40	Jan-78		Requested		2236.96	
2538		2 Palm Pilots	Jun-03		Broke		3059.77	
3471		12 File Cabinets					3674.91	
3488		Headsets					4312.51	
3560		25 file cabinets					1553.09	
3611		Floor Mats					3293.89	
3662		Chair					4390.63	
1403		1992 Econoline Van		17,170.50	Sold			
1952		Cat D6c Dozer		35,000.00	Sold			
2131		1991 International Truck		15,000.00	Sold			
2628		2004 Ford Crown Victoria		21,474.55	Sold			
2887		2002 Ford Crown Vic		12,000.00	Sold			
3084		2003 Crown Victoria		9,795.00	Sold			
3269		2007 Mercury Grand Marq		13,730.42	Sold			
3267		204 Ford Crown Victoria		10,500.00	Sold			
3302		2008 Ford Pickup		29,900.00	Sold			
3422		2009 Dodge Charger		19,755.00	Sold			
3423		2009 Dodge Charger		20,724.00	Sold			
3269		Light Equipment		1,285.33	Sold			
3746		Dodge Ram Van		1,000.00	Sold			
3425	Misc	NEC Vivid 2020 Copier		6,900.00	Donated			
3426	Misc	CX 2032 Print Copy Scan		1,810.00	Donated			
3427		Desktop PC/Server		1,941.00	Donated			
3429		Laptop		849.95	Donated			
3428		Laptop		849.95	Donated			
				120,706.04				
3590	Co Cl	File Cabinets		1,407.12				
3501	Dst Crt	Chair		2,176.00				
3490	SO	Light Equipment		9,140.02	Sold			
3085	Co Clerk	HP 4350		2,666.00	Broken			
2067	Dst Clerk	20 Storage Shelves		1,262.72				
2114	Dst Clerk	Shelves		1,859.10				
		Totia		525,603.21		166700.51	1349.99	
				525,603.21			494741.35	
							494741.35	

Category	Bill #	Captions/Details	Effective Date
DC	SB 1759	Relating to the procedures for the appointment of and the duties of attorneys ad litem in certain suits affecting the parent-child relationship. Requires attorneys who provide ad litem services to have 3 hour continuing education relating to representing a child protective case. Requires an attorney appointed as an ad litem for a child to obtain 3 hours of CLE related to representing a child in CPS cases as soon as possible after appointment. Requires those on a list to obtain 3 hours of related CLE per year. Expands when an ad litem must be appointed for certain parents; currently it is in cases where termination of parental rights sought and this expands it to include cases in which a conservator for the child is sought. In such cases, the attorney is now required to obtain 3 hours of CLE related to representing a parent in such cases and is required to abide by the parent's objectives for representation. Attorneys on the list must get the 3 hours each year.	9/1/2013
Fees & Fines			
		Due to the passage of SB 390, all new and amended court costs and fees have an effective date of 1/1/2014.	
CC-DC	HB 410	Relating to the administration and operation of the appellate judicial system for the Second Court of Appeals District. It is only applicable to counties within the 2nd Court of Appeals.	9/1/2013 (Fee effective 1/1/2014)
* CC-DC	HB 1513	Relating to increases in the records archive fees and the records management and preservation fees charged by district and county clerks. Increases fees to \$10. Requires commissioner's court approval and budget approval for district court records archive fee. The bill contains a provision reverting back to the \$5 fee effective 9/1/2019.	9/1/2013 (Increase in fees are effective 1/1/2014)
CC-DC	HB 2302	Relating to the establishment of the statewide electronic filing system fund and to certain court fees and court costs to fund the account. Allows judge to electronically sign documents. Adds \$20 civil filing fee, \$10 justice court fee on civil actions and \$5 criminal court costs for the statewide e-filing system are effective 9/1/13. Allows counties to collect \$2 per transaction e-filing fee if such is necessary to recoup cost of implementing e-filing system; must certify to OCA annually the fee is necessary. \$2 transaction fee provision expires 9/1/19. Do not collect a \$20 e-filing fee on family lawsuits for filing a suit or motion for modification; motion for enforcement; a notice of application for judicial writ of withholding; a motion to transfer; a petition for license suspension; or a motion for contempt. Continue to collect the \$15 filing fee. (Family Code, §110.002)	9/1/2013 (Per OCA, the \$20 civil e-filing fee, \$10 justice court fee and \$5 criminal court costs are effective on 9/1/2013.)
CC-DC	SB 389	Relating to the imposition of court costs in certain criminal proceedings. Calculation of fees and fines are based on the date of conviction. Definition of definition in CCP Art. 102.005 includes deferred and probation.	6/14/2013
CC-DC	SB 390	Relating to the effective date of a new court cost or fee or of an amendment to the amount of a court cost or fee. Government Code 51.607(d) was repealed while the rest of 51.607 was left intact. Therefore, now all new or amended fees will be effective January 1 of the year following the effective date of the bill creating or amending the fee. The provision that said the new fee started on the date specified in legislation was repealed, which means 51.607(c) controls. 51.607(c) reads, "Notwithstanding the effective date of the law imposing or changing the amount of a court cost or fee included on the list, the imposition or change in the amount of the court cost or fee does not take effect until the next January 1 after the law takes effect."	6/14/2013.
CC-DC	SB 391	Relating to a defendant's obligation to pay a fine or court cost after the expiration of a period of community service. Clarifies that the obligation to pay court costs, fees, and fines remains even after the probation period has been discharged.	9/1/2013
CC	SB 395	Relating to fines and court costs imposed on a child in a criminal case. This is a JP/muni court-related bill. This provides that a child convicted of a class C misdemeanor can elect to discharge the fines and fees through community service, receiving tutoring, or paying them.	9/1/2013
CC-DC	SB 967	Relating to the authority of a municipality or county to retain certain service fees. This bill is not related to the 90% C.J.S reporting. It is related to the requirement to implement a Collections Improvement Plan. Under current law, if a city or county is not in compliance with the requirement to have a Collections Improvement Plan under CCP 103.0033, then the city or county cannot retain the 10% service fee under Local Government Code 133.058 and instead must send all of the fees collected to the Comptroller. There is a provision in current law that gives the cities a 180-day grace period to get back in compliance before losing this service fee. SB967 gives that same 180-day grace period to counties.	6/14/2013
CC-DC	SB 1827	Relating to additional fee for filing civil cases in certain Rockwell County Courts. Additional \$15 fee.	6/14/2013 (Fee effective 1/1/2014)

Resolution

Whereas: Section 191.022, Subsection (b) Texas Health and Safety code, provides that the municipal clerk or secretary is the local registrar of births and deaths in a municipality with a population of 2,500 or more; and

Whereas: Section 191.023, Subsection (a) provides that the duties imposed by law relating to the maintenance of birth and death records of a municipality with a population of 2,500 or more may be transferred to the county in which the municipality is located.

Whereas: The County Office, in accordance with Section 191.023, subsection (b) has attested that the office of **Montague County Clerk** has sufficient resources and finances to assume those duties; and,

Whereas: The office of the **City of Bowie**, Montague County, Texas desires to consolidate the birth, death, and fetal death records of the municipality and **Montague County Clerk** by complying with Section 191.023, Subsection (b) that requires that the municipality adopt a concurring resolution agreeing to the transfer and timetable established, said resolution to be considered at the 8-6-13 regular meeting of the **City of Bowie Council**; and

Whereas: The citizens of **Montague County** would be better served by having all birth and death records in a central location.

Now, therefore be it **RESOLVED**, by **Montague County Commissioner's Court of Montague County, Texas** that:

Effective 7-22-13, the **Montague County Clerk's Office of Montague County, Texas** and the **Commissioner's Court of Montague County, Texas** hereby accept the consolidation and transfer of the maintenance of birth and death records of the **City of Bowie**, a municipality with a population of more the 2,500 and all duties imposed Title 3 of the Texas Health and Safety Code related thereto.

Adopted at a regular meeting of the **Commissioner's Court, Montague County, Texas** on 7-22-13.

Honorable J. J. ...

Herman Conway Pct. 1
Mark Maly Pct 3
Donda ...

Agnes ...
Bob ...

ATTEST *Donda ...* CLERK, COUNTY COURT CLERK-EX-OFFICIO CLERK OF THE COMMISSIONER'S COURT, MONTAGUE COUNTY, TEXAS

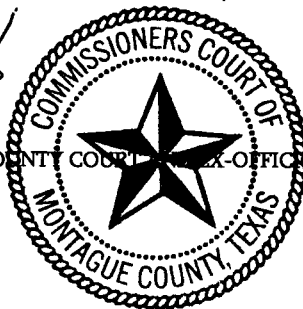

Resolution

Whereas: Section 191.022, Subsection (b) Texas Health and Safety code, provides that the municipal clerk or secretary is the local registrar of births and deaths in a municipality with a population of 2,500 or more; and

Whereas: Section 191.023, Subsection (a) provides that the duties imposed by law relating to the maintenance of birth and death records of a municipality with a population of 2,500 or more may be transferred to the county in which the municipality is located.

Whereas: The County Office, in accordance with Section 191.023, subsection (b) has attested that the office of **Montague County Clerk** has sufficient resources and finances to assume those duties; and,

Whereas: The office of the **City of Nocona**, Montague County, Texas desires to consolidate the birth, death, and fetal death records of the municipality and **Montague County Clerk** by complying with Section 191.023, Subsection (b) that requires that the municipality adopt a concurring resolution agreeing to the transfer and timetable established, said resolution to be considered at the 7-9-13 regular meeting of the **City of Nocona Council**; and

Whereas: The citizens of **Montague County** would be better served by having all birth and death records in a central location.

Now, therefore be it **RESOLVED**, by **Montague County Commissioner's Court of Montague County, Texas** that:

Effective 7-22-13, the **Montague County Clerk's Office of Montague County, Texas** and the **Commissioner's Court of Montague County, Texas** hereby accept the consolidation and transfer of the maintenance of birth and death records of the **City of Nocona**, a municipality with a population of more the 2,500 and all duties imposed Title 3 of the Texas Health and Safety Code related thereto.

Adopted at a regular meeting of the **Commissioner's Court, Montague County, Texas** on 7-22-13

Donnie Dappington

Herman Conway Pct. 1
Mark Mynoy Pct 3
Jonda Hudson



James Stambler Pct 2
BT LR

ATTEST: *Jonda Hudson* CLERK, COUNTY COURT AND EX OFFICIO CLERK OF THE COMMISSIONER'S COURT, MONTAGUE COUNTY, TEXAS

RESOLUTION OF MONTAGUE COUNTY AUTHORIZING AND APPROVING THE APPOINTMENT AND REAPPOINTMENT OF INDIVIDUALS TO THE BOARD OF DIRECTORS OF THE NORTEX HOUSING FINANCE CORPORATION.

WHEREAS, pursuant to the Texas Housing Finance Corporation Act, Chapter 394, Texas Local Government Code, as amended, the Texas counties of Archer, Baylor, Clay, Cottle, Foard, Hardeman, Jack, Montague, Wichita, Wilbarger, and Young, Texas (collectively, the "Sponsoring Entities") have formed a joint housing finance corporation named the Nortex Housing Finance Corporation (the "Corporation") to provide a means of financing the cost of residential ownership and development that will provide decent, safe and sanitary housing for persons and families of low and moderate income; and

WHEREAS, Montague County is a member of the Corporation and has authorized the Corporation to act on its behalf and on behalf of the other Sponsoring Entities for the purposes set forth in the previous paragraph; and

WHEREAS, in accordance with the Articles of Incorporation and the Bylaws of the Corporation, a majority of the Sponsoring Entities must approve the appointment and/or reappointment of members of the Board of Directors of the Corporation; and

WHEREAS, in accordance with the Articles of Incorporation and the Bylaws of the Corporation, Montague County together with the Sponsoring Entities desires to appoint/reappoint existing members of the Board of Directors of the Corporation upon resignation or expiration of their current terms.

NOW, THEREFORE, Be It Resolved By the Commissioner Court of Montague County that:

Section 1. Board of Directors. That the following appointment and reappointment for the Board of Directors of the Corporation and the length of the term thereof are hereby authorized and approved;

<u>DIRECTOR</u>	<u>CURRENT TERM EXPIRES</u>	<u>NEWLY REAPPOINTED TERM EXPIRES</u>
Dennis Wilde	Reappointment	August 1, 2018

Section 2. Effective Date. That this Resolution shall be in full force and effect from and upon its adoption.

PASSED AND APPROVED this 27th day of July 2013.

By [Signature]
Title: Montague County Judge

ATTEST:

By [Signature]
Title: County Clerk



ORDER GRANTING PERMIT AND RIGHT-OF-WAY TO CONSTRUCT GAS PIPELINE

STATE OF TEXAS X PIONEER NATURAL RESOURCES
COUNTY OF MONTAGUE X

Now, on this the 22nd day JULY, 2013, at a regular Term and Session of the Commissioner's Court of Montague County, Texas, can on to be considered the application of PIONEER NATURAL RESOURCES USA, INC. for a permit and right-of-way to lay, construct, maintain, operate a ROAD CROSSING on DITTO ROAD located in Precinct #1 of the County of Montague, State of Texas, and the court having considered such application which is here referred to and made a part hereof, and having determined that the permit and right-of-way for such pipeline should be granted, it is accordingly ordered by the Court:

- 1. That the County of Montague, State of Texas, does hereby grant the right, privilege and right-of-way to PIONEER NATURAL RESOURCES USA, INC., to lay, construct, maintain, operate a pipeline along, over, across or under the public roads, streets, alleyways of the County of Montague, State of Texas.
2. That such pipeline shall be so buried, cased, covered, constructed and maintained as not to interfere with the use and occupancy of such roads by public. Said pipeline shall be buried 3 feet below bar ditches.
3. That any adjustments of said pipeline required for any State Farm to Market Road or any other improved road would be at 100 per cent cost to PIONEER NATURAL RESOURCES USA, INC.
4. That all the rights, privileges and right-of-way herein above mentioned are by this order duly vested in said PIONEER NATURAL RESOURCES USA, INC., its successors and assigns, without further grant or procedure.

Tommie Sappington
Tommie Sappington, County Judge

STATE OF TEXAS X PIONEER NATURAL RESOURCES
COUNTY OF MONTAGUE X

Before me, the undersigned authority, on this personally appeared Tommie Sappington, known to me to be the person whose name is subscribed to the foregoing instrument and acknowledged to me that he executed the same for the purposes and consideration therein expressed and in the capacity therein stated.

Given under my hand and seal of office this 22ND day of JULY, 2013.

My commission expires:

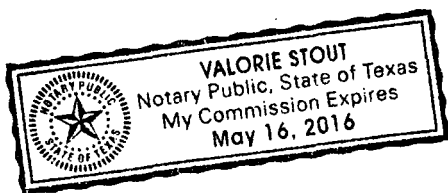

Valorie Stout
Notary Public in and for Montague County, Texas

checkmark

MONTAGUE COUNTY
APPLICATION FOR A PERMIT AND RIGHT-OF-WAY

DATE: July 5, 2013

NAME: Pioneer Natural Resources USA, Inc.

ADDRESS: 925 University Drive, Fort Worth, Texas 76107

CONTACT PERSON: Beverly Davis TELEPHONE NO. 817-408-7777

ROAD NAME: Ditto Road COMMISSIONER PCT. 1 2 3

GPS Coordinates: Latitude 33°30'37.3349" Longitude 97°44'52.0424"

(GPS Coordinates for Road Crossings)
 TEMPORARY PERMANENT PLAT ATTACHED

This document is an application for a permit and right-of-way. Please give a descriptive explanation of the work to be done:

Pioneer Natural Resources USA, Inc. is proposing to install a natural gas pipeline under the above named County Road as depicted on the attached location drawing.

If your application for the permit and right-of-way is approved by the Montague County Commissioners Court and an Order to grant the permit and right-of-way for such pipeline should be granted, the following is understood:

1. That such pipeline shall be so buried, cased, covered, constructed and maintained as not to interfere with the use and occupancy of such roads by public.
2. That any adjustments of said pipeline required for any State Farm to Market Road or any other improved road would be at 100 per cent cost to the applicant.
3. That all the rights, privileges and right-of-ways will be vested in said Applicant and its successors and assigns, without further grant or procedure.
4. Fees may or may not apply. If fees apply, fees need to accompany the application.
5. Notice of all applications will be sent to the Upper Trinity Groundwater Conservation District.

Source of the water:

Full Name and Address of Property Owner: _____

Well Site Physical Address: _____ UTGCD ID#: _____

Type of Water Used:

Surface Water	_____	Percentage
Ground Water	_____	Percentage
Both	_____	Percentage

GPS Coordinates: Latitude _____ Longitude _____

5334

Meter Serial Number: _____

Beginning Meter Reading (as displayed on meter): _____

Ending Meter Reading (as displayed on meter): _____

Location of the use of the water: _____ County: _____

Will any of this water be transported for use outside of the District (Montague, Parker, Wise, and Hood Counties)? Yes No

If yes, explain how the water was measured and include amount transported. _____

AFFIRMATION

I HEREBY SWEAR OR AFFIRM THAT THE INFORMATION INCLUDED IN THIS REPORT IS TRUE AND CORRECT TO THE BEST OF MY KNOWLEDGE.

DATE July 5, 2013

SIGNATURE Beverly Davis

MONTAGUE COUNTY, TEXAS
 TITUS COUNTY SCHOOL LAND SURVEY, A-730

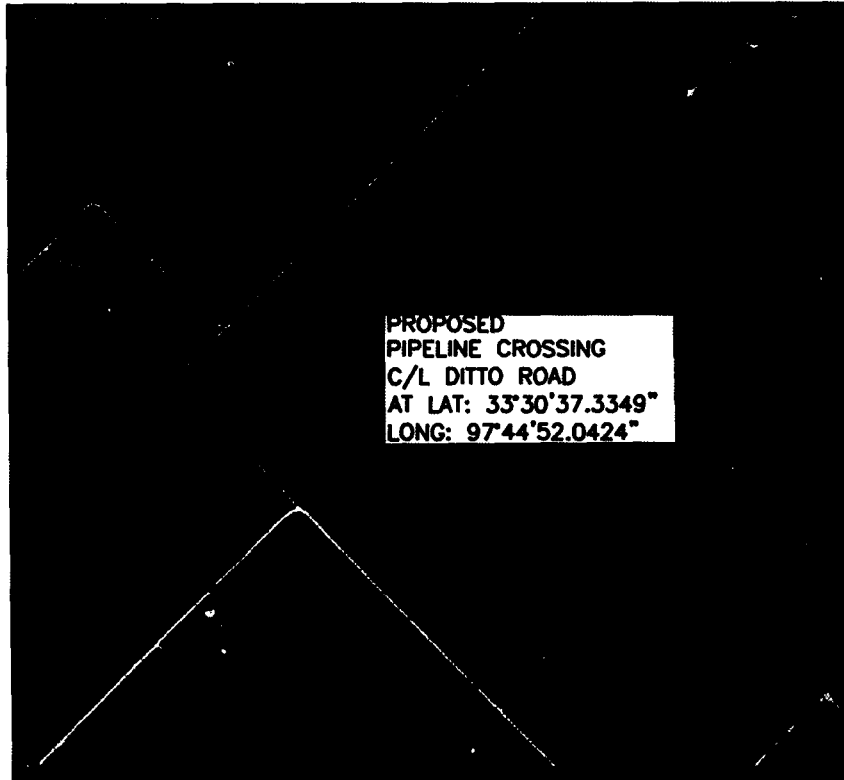

LOCATION MAP
 N.T.S.



TRWA INC.
 925 UNIVERSITY DRIVE
 FORT WORTH, TEXAS 76107
 817-361-8839

TEXAS RIGHT OF WAY ASSOCIATES
 MAPPING DIVISION
LICENSE NO. 1013000 COPYRIGHT © 2012

PROPOSED PIPELINE LOCATION
 PIONEER NATURAL RESOURCES USA, INC.
 CROSSING COUNTY ROAD
 DITTO ROAD
 TITUS COUNTY SCHOOL LAND SURVEY, A-730

DRAWN BY: BL/JNR	DATE: 06/27/13
CHECKED BY: E.S.H.	DATE: 06/27/13
SCALE: N.T.S.	PAGE: 1 OF 1

SML31 6.0_
 DITTO RD

MONTAGUE COUNTY,

TEXAS

ORDER GRANTING PERMIT AND RIGHT-OF-WAY
TO CONSTRUCT GAS PIPELINE

STATE OF TEXAS X PIONEER NATURAL RESOURCES
X
COUNTY OF MONTAGUE X

Now, on this the 22nd day JULY, 2013, at a regular Term and Session of the Commissioner's Court of Montague County, Texas, can on to be considered the application of PIONEER NATURAL RESOURCES USA, INC. for a permit and right-of-way to lay, construct, maintain, operate a ROAD CROSSING on DITTO ROAD located in Precinct #1 of the County of Montague, State of Texas, and the court having considered such application which is here referred to and made a part hereof, and having determined that the permit and right-of-way for such pipeline should be granted, it is accordingly ordered by the Court:

1. That the County of Montague, State of Texas, does hereby grant the right, privilege and right-of-way to PIONEER NATURAL RESOURCES USA, INC., to lay, construct, maintain, operate a pipeline along, over, across or under the public roads, streets, alleyways of the County of Montague, State of Texas.
2. That such pipeline shall be so buried, cased, covered, constructed and maintained as not to interfere with the use and occupancy of such roads by public. Said pipeline shall be buried 3 feet below bar ditches.
3. That any adjustments of said pipeline required for any State Farm to Market Road or any other improved road would be at 100 per cent cost to PIONEER NATURAL RESOURCES USA, INC.
4. That all the rights, privileges and right-of-way herein above mentioned are by this order duly vested in said PIONEER NATURAL RESOURCES USA, INC., its successors and assigns, without further grant or procedure.

Tommie Sappington
Tommie Sappington, County Judge

STATE OF TEXAS X PIONEER NATURAL RESOURCES
X
COUNTY OF MONTAGUE X

Before me, the undersigned authority, on this personally appeared Tommie Sappington, known to me to be the person whose name is subscribed to the foregoing instrument and acknowledged to me that he executed the same for the purposes and consideration therein expressed and in the capacity therein stated.

Given under my hand and seal of office this 22ND day of JULY, 2013.

My commission expires:

Valerie Stout
Notary Public in and for
Montague County, Texas

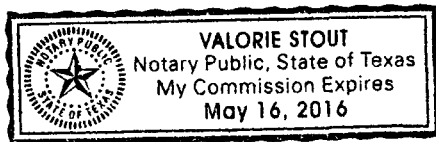

✓

MONTAGUE COUNTY
APPLICATION FOR A PERMIT AND RIGHT-OF-WAY

DATE: July 5, 2013

NAME: Pioneer Natural Resources USA, Inc.

ADDRESS: 925 University Drive, Fort Worth, Texas 76107

CONTACT PERSON: Beverly Davis TELEPHONE NO. 817-408-7777

ROAD NAME: Ditto Road COMMISSIONER PCT. 1 2 3

GPS Coordinates: Latitude 33°30'59.23503" Longitude 97°44'26.43639"

(GPS Coordinates for Road Crossings)
 TEMPORARY X PERMANENT PLAT ATTACHED

This document is an application for a permit and right-of-way. Please give a descriptive explanation of the work to be done:

Pioneer Natural Resources USA, Inc. is proposing to install a natural gas pipeline under the above named County Road as depicted on the attached location drawing.

If your application for the permit and right-of-way is approved by the Montague County Commissioners Court and an Order to grant the permit and right-of-way for such pipeline should be granted, the following is understood:

1. That such pipeline shall be so buried, cased, covered, constructed and maintained as not to interfere with the use and occupancy of such roads by public.
2. That any adjustments of said pipeline required for any State Farm to Market Road or any other improved road would be at 100 per cent cost to the applicant.
3. That all the rights, privileges and right-of-ways will be vested in said Applicant and its successors and assigns, without further grant or procedure.
4. Fees may or may not apply. If fees apply, fees need to accompany the application.
5. Notice of all applications will be sent to the Upper Trinity Groundwater Conservation District.

Source of the water:

Full Name and Address of Property Owner: _____

Well Site Physical Address: _____ UTGCD ID#: _____

Type of Water Used:

Surface Water	_____	Percentage
Ground Water	_____	Percentage
Both	_____	Percentage

GPS Coordinates: Latitude _____ Longitude _____

5334

Meter Serial Number: _____

Beginning Meter Reading (as displayed on meter): _____

Ending Meter Reading (as displayed on meter): _____

Location of the use of the water: _____ County: _____

Will any of this water be transported for use outside of the District (Montague, Parker, Wise, and Hood Counties)? Yes No

If yes, explain how the water was measured and include amount transported. _____

AFFIRMATION

I HEREBY SWEAR OR AFFIRM THAT THE INFORMATION INCLUDED IN THIS REPORT IS TRUE AND CORRECT TO THE BEST OF MY KNOWLEDGE.

DATE 7-5-2013

SIGNATURE *Beverly Davis*

MONTAGUE COUNTY, TEXAS

TITUS COUNTY SCHOOL LAND SURVEY, A-730

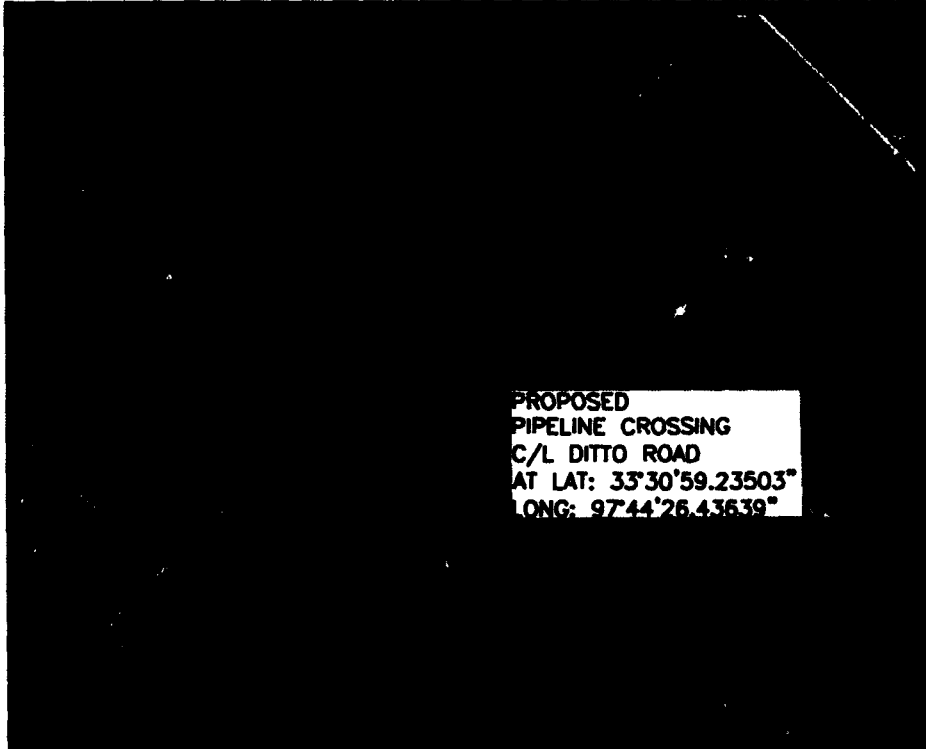

LOCATION MAP
N.T.S.

R1 TO REROUTE OFF OF KESEY TRACT.



TRWA INC.
925 UNIVERSITY DRIVE
FORT WORTH, TEXAS 76107
817-361-8839

TEXAS RIGHT OF WAY ASSOCIATES
MAPPING DIVISION
LICENSE NO. 1013880
COPYRIGHT © 2012

PROPOSED PIPELINE LOCATION
PIONEER NATURAL RESOURCES USA, INC.
CROSSING COUNTY ROAD
DITTO ROAD
TITUS COUNTY SCHOOL LAND SURVEY, A-730

DRAWN BY: BL/JNR	DATE: 07/09/13
CHECKED BY: E.S.H.	DATE: 07/09/13
SCALE: N.T.S.	PAGE: 1 OF 1

SML31 3.0_
DITTO RD-R1

MONTAGUE COUNTY,

TEXAS

ORDER GRANTING PERMIT AND RIGHT-OF-WAY
TO CONSTRUCT GAS PIPELINE

STATE OF TEXAS	X	PIONEER NATURAL RESOURCES
	X	
COUNTY OF MONTAGUE	X	

Now, on this the 22nd day JULY, 2013, at a regular Term and Session of the Commissioner's Court of Montague County, Texas, can on to be considered the application of PIONEER NATURAL RESOURCES USA, INC. for a permit and right-of-way to lay, construct, maintain, operate a ROAD CROSSING on DOG KENNEL ROAD located in Precinct #2 of the County of Montague, State of Texas, and the court having considered such application which is here referred to and made a part hereof, and having determined that the permit and right-of-way for such pipeline should be granted, it is accordingly ordered by the Court:

1. That the County of Montague, State of Texas, does hereby grant the right, privilege and right-of-way to PIONEER NATURAL RESOURCES USA, INC., to lay, construct, maintain, operate a pipeline along, over, across or under the public roads, streets, alleyways of the County of Montague, State of Texas.
2. That such pipeline shall be so buried, cased, covered, constructed and maintained as not to interfere with the use and occupancy of such roads by public. Said pipeline shall be buried 3 feet below bar ditches.
3. That any adjustments of said pipeline required for any State Farm to Market Road or any other improved road would be at 100 per cent cost to PIONEER NATURAL RESOURCES USA, INC.
4. That all the rights, privileges and right-of-way herein above mentioned are by this order duly vested in said PIONEER NATURAL RESOURCES USA, INC., its successors and assigns, without further grant or procedure.

Tommie Sappington
Tommie Sappington, County Judge

STATE OF TEXAS	X	PIONEER NATURAL RESOURCES
	X	
COUNTY OF MONTAGUE	X	

Before me, the undersigned authority, on this personally appeared Tommie Sappington, known to me to be the person whose name is subscribed to the foregoing instrument and acknowledged to me that he executed the same for the purposes and consideration therein expressed and in the capacity therein stated.

Given under my hand and seal of office this 22ND day of JULY, 2013.

My commission expires:

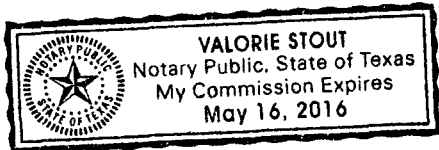

Valorie Stout
Notary Public in and for
Montague County, Texas

✓

MONTAGUE COUNTY
APPLICATION FOR A PERMIT AND RIGHT-OF-WAY

DATE: July 5, 2013

NAME: Pioneer Natural Resources USA, Inc.

ADDRESS: 925 University Drive, Fort Worth, Texas 76107

CONTACT PERSON: Beverly Davis TELEPHONE NO. 817-408-7777

ROAD NAME: Dog Kennel Road COMMISSIONER PCT. 1 2 3

GPS Coordinates: Latitude 33°29'25.2895" Longitude 97°45'43.9421"

(GPS Coordinates for Road Crossings)

 TEMPORARY X PERMANENT PLAT ATTACHED

This document is an application for a permit and right-of-way. Please give a descriptive explanation of the work to be done:

Pioneer Natural Resources USA, Inc. is proposing to install a natural gas pipeline under the above named County Road as depicted on the attached location drawing.

If your application for the permit and right-of-way is approved by the Montague County Commissioners Court and an Order to grant the permit and right-of-way for such pipeline should be granted, the following is understood:

1. That such pipeline shall be so buried, cased, covered, constructed and maintained as not to interfere with the use and occupancy of such roads by public.
2. That any adjustments of said pipeline required for any State Farm to Market Road or any other improved road would be at 100 per cent cost to the applicant.
3. That all the rights, privileges and right-of-ways will be vested in said Applicant and its successors and assigns, without further grant or procedure.
4. Fees may or may not apply. If fees apply, fees need to accompany the application.
5. Notice of all applications will be sent to the Upper Trinity Groundwater Conservation District.

Source of the water:

Full Name and Address of Property Owner: _____

Well Site Physical Address: _____ UTGCD ID#: _____

Type of Water Used:

Surface Water	_____	Percentage
Ground Water	_____	Percentage
Both	_____	Percentage

GPS Coordinates: Latitude _____ Longitude _____

5334

Meter Serial Number: _____

Beginning Meter Reading (as displayed on meter): _____

Ending Meter Reading (as displayed on meter): _____

Location of the use of the water: _____ County: _____

Will any of this water be transported for use outside of the District (Montague, Parker, Wise, and Hood Counties)? Yes No

If yes, explain how the water was measured and include amount transported. _____

AFFIRMATION

I HEREBY SWEAR OR AFFIRM THAT THE INFORMATION INCLUDED IN THIS REPORT IS TRUE AND CORRECT TO THE BEST OF MY KNOWLEDGE.

DATE July 5, 2013

SIGNATURE Lenevy Davis

MONTAGUE COUNTY, TEXAS
 TITUS COUNTY SCHOOL LAND SURVEY, A-730

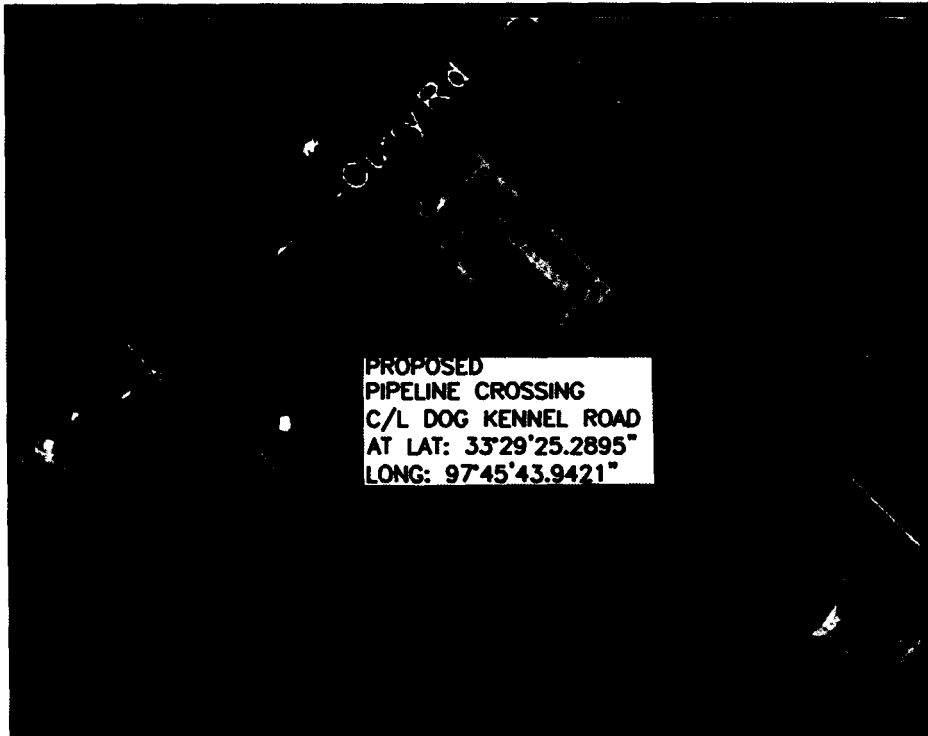

LOCATION MAP
 N.T.S.

		TRWA, INC. <small>925 UNIVERSITY DRIVE FORT WORTH, TEXAS 76107 817-361-8839</small>	TEXAS RIGHT OF WAY ASSOCIATES MAPPING DIVISION <small>LICENSE NO. 1013880 COPYRIGHT © 2012</small>
		PROPOSED PIPELINE LOCATION PIONEER NATURAL RESOURCES USA, INC. CROSSING COUNTY ROAD DOG KENNEL ROAD TITUS COUNTY SCHOOL LAND SURVEY, A-730 MONTAGUE COUNTY, TEXAS	
DRAWN BY: BL/JNR CHECKED BY: E.S.H. SCALE: N.T.S.	DATE: 06/28/13 DATE: 06/28/13 PAGE: 1 OF 1	SML31 17.0_ DOG KENNEL RD	

ORDER GRANTING PERMIT AND RIGHT-OF-WAY
TO CONSTRUCT GAS PIPELINE

STATE OF TEXAS	X	PIONEER NATURAL RESOURCES
	X	
COUNTY OF MONTAGUE	X	

Now, on this the 22nd day JULY, 2013, at a regular Term and Session of the Commissioner's Court of Montague County, Texas, can on to be considered the application of PIONEER NATURAL RESOURCES USA, INC. for a permit and right-of-way to lay, construct, maintain, operate a ROAD CROSSING on ORCHARD ROAD located in Precinct #2 of the County of Montague, State of Texas, and the court having considered such application which is here referred to and made a part hereof, and having determined that the permit and right-of-way for such pipeline should be granted, it is accordingly ordered by the Court:

1. That the County of Montague, State of Texas, does hereby grant the right, privilege and right-of-way to PIONEER NATURAL RESOURCES USA, INC., to lay, construct, maintain, operate a pipeline along, over, across or under the public roads, streets, alleyways of the County of Montague, State of Texas.
2. That such pipeline shall be so buried, cased, covered, constructed and maintained as not to interfere with the use and occupancy of such roads by public. Said pipeline shall be buried 3 feet below bar ditches.
3. That any adjustments of said pipeline required for any State Farm to Market Road or any other improved road would be at 100 per cent cost to PIONEER NATURAL RESOURCES USA, INC.
4. That all the rights, privileges and right-of-way herein above mentioned are by this order duly vested in said PIONEER NATURAL RESOURCES USA, INC., its successors and assigns, without further grant or procedure.

Tommie Sappington

Tommie Sappington, County Judge

STATE OF TEXAS	X	PIONEER NATURAL RESOURCES
	X	
COUNTY OF MONTAGUE	X	

Before me, the undersigned authority, on this personally appeared Tommie Sappington, known to me to be the person whose name is subscribed to the foregoing instrument and acknowledged to me that he executed the same for the purposes and consideration therein expressed and in the capacity therein stated.

Given under my hand and seal of office this 22ND day of JULY, 2013.

My commission expires:

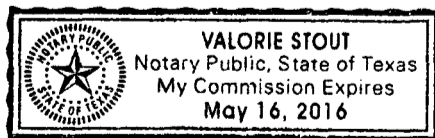

Valorie Stout

Notary Public in and for
Montague County, Texas

✓

MONTAGUE COUNTY
APPLICATION FOR A PERMIT AND RIGHT-OF-WAY

DATE: July 5, 2013

NAME: Pioneer Natural Resources USA, Inc.

ADDRESS: 925 University Drive, Fort Worth, Texas 76107

CONTACT PERSON: Beverly Davis TELEPHONE NO. 817-408-7777

ROAD NAME: Orchard Road COMMISSIONER PCT. 1 (2) 3

GPS Coordinates: Latitude 33°30'09.5841" Longitude 97°45'05.3008"

(GPS Coordinates for Road Crossings)
 TEMPORARY X PERMANENT PLAT ATTACHED

This document is an application for a permit and right-of-way. Please give a descriptive explanation of the work to be done:

Pioneer Natural Resources USA, Inc. is proposing to install a natural gas pipeline under the above named County Road as depicted on the attached location drawing.

If your application for the permit and right-of-way is approved by the Montague County Commissioners Court and an Order to grant the permit and right-of-way for such pipeline should be granted, the following is understood:

1. That such pipeline shall be so buried, cased, covered, constructed and maintained as not to interfere with the use and occupancy of such roads by public.
2. That any adjustments of said pipeline required for any State Farm to Market Road or any other improved road would be at 100 per cent cost to the applicant.
3. That all the rights, privileges and right-of-ways will be vested in said Applicant and its successors and assigns, without further grant or procedure.
4. Fees may or may not apply. If fees apply, fees need to accompany the application.
5. Notice of all applications will be sent to the Upper Trinity Groundwater Conservation District.

Source of the water:

Full Name and Address of Property Owner: _____

Well Site Physical Address: _____ UTGCD ID#: _____

Type of Water Used:

Surface Water	_____	Percentage
Ground Water	_____	Percentage
Both	_____	Percentage

GPS Coordinates: Latitude _____ Longitude _____

5334

Meter Serial Number: _____

Beginning Meter Reading (as displayed on meter): _____

Ending Meter Reading (as displayed on meter): _____

Location of the use of the water: _____ County: _____

Will any of this water be transported for use outside of the District (Montague, Parker, Wise, and Hood Counties)? Yes No

If yes, explain how the water was measured and include amount transported. _____

AFFIRMATION

I HEREBY SWEAR OR AFFIRM THAT THE INFORMATION INCLUDED IN THIS REPORT IS TRUE AND CORRECT TO THE BEST OF MY KNOWLEDGE.

DATE July 5, 2013

SIGNATURE *Dorely Davis*

MONTAGUE COUNTY, TEXAS

TITUS COUNTY SCHOOL LAND SURVEY, A-730

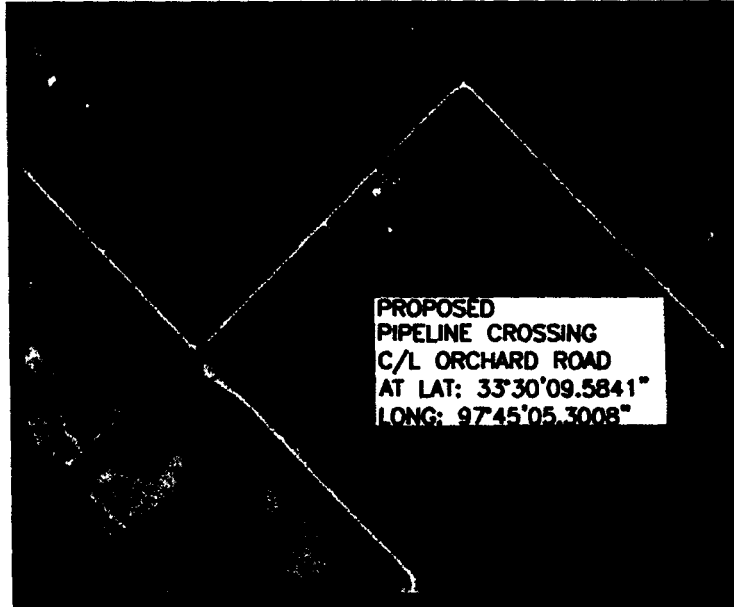

LOCATION MAP
N.T.S.



TRWA INC.
925 UNIVERSITY DRIVE
FORT WORTH, TEXAS 76107
817-361-8839

TEXAS RIGHT OF WAY ASSOCIATES
MAPPING DIVISION
LICENSE NO. 101260 COPYRIGHT © 2012

PROPOSED PIPELINE LOCATION
PIONEER NATURAL RESOURCES USA, INC.
CROSSING COUNTY ROAD
ORCHARD ROAD
TITUS COUNTY SCHOOL LAND SURVEY, A-730

DRAWN BY: BL/JNR DATE: 06/28/13

CHECKED BY: E.S.H. DATE: 06/28/13

SCALE: N.T.S. PAGE: 1 OF 1

SML31 9.0_
ORCHARD RD

MONTAGUE COUNTY,

TEXAS

ORDER GRANTING PERMIT AND RIGHT-OF-WAY
TO CONSTRUCT GAS PIPELINE

STATE OF TEXAS	X	PIONEER NATURAL RESOURCES
	X	
COUNTY OF MONTAGUE	X	

Now, on this the 22nd day JULY, 2013, at a regular Term and Session of the Commissioner's Court of Montague County, Texas, can on to be considered the application of **PIONEER NATURAL RESOURCES USA, INC.** for a permit and right-of-way to lay, construct, maintain, operate a ROAD CROSSING on SMYRNA ROAD located in Precinct #2 of the County of Montague, State of Texas, and the court having considered such application which is here referred to and made a part hereof, and having determined that the permit and right-of-way for such pipeline should be granted, it is accordingly ordered by the Court:

1. That the County of Montague, State of Texas, does hereby grant the right, privilege and right-of-way to PIONEER NATURAL RESOURCES USA, INC., to lay, construct, maintain, operate a pipeline along, over, across or under the public roads, streets, alleyways of the County of Montague, State of Texas.
2. That such pipeline shall be so buried, cased, covered, constructed and maintained as not to interfere with the use and occupancy of such roads by public. Said pipeline shall be buried 3 feet below bar ditches.
3. That any adjustments of said pipeline required for any State Farm to Market Road or any other improved road would be at 100 per cent cost to PIONEER NATURAL RESOURCES USA, INC.
4. That all the rights, privileges and right-of-way herein above mentioned are by this order duly vested in said PIONEER NATURAL RESOURCES USA, INC., its successors and assigns, without further grant or procedure.

Tommie Sappington

Tommie Sappington, County Judge

STATE OF TEXAS	X	PIONEER NATURAL RESOURCES
	X	
COUNTY OF MONTAGUE	X	

Before me, the undersigned authority, on this personally appeared Tommie Sappington, known to me to be the person whose name is subscribed to the foregoing instrument and acknowledged to me that he executed the same for the purposes and consideration therein expressed and in the capacity therein stated.

Given under my hand and seal of office this 22ND day of JULY, 2013.

My commission expires:

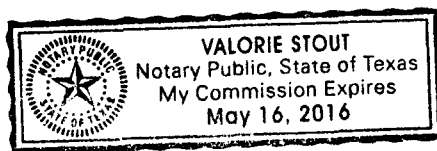

Valorie Stout

Notary Public in and for
Montague County, Texas

↓

MONTAGUE COUNTY
APPLICATION FOR A PERMIT AND RIGHT-OF-WAY

DATE: July 5, 2013

NAME: Pioneer Natural Resources USA, Inc.

ADDRESS: 925 University Drive, Fort Worth, Texas 76107

CONTACT PERSON: Beverly Davis TELEPHONE NO. 817-408-7777

ROAD NAME: Smyrna Road COMMISSIONER PCT. 1 (2) 3

GPS Coordinates: Latitude 33°29'30.8846" Longitude 97°45'05.2029"

(GPS Coordinates for Road Crossings)

 TEMPORARY X PERMANENT PLAT ATTACHED

This document is an application for a permit and right-of-way. Please give a descriptive explanation of the work to be done:

Pioneer Natural Resources USA, Inc. is proposing to install a natural gas pipeline under the above named County Road as depicted on the attached location drawing.

If your application for the permit and right-of-way is approved by the Montague County Commissioners Court and an Order to grant the permit and right-of-way for such pipeline should be granted, the following is understood:

1. That such pipeline shall be so buried, cased, covered, constructed and maintained as not to interfere with the use and occupancy of such roads by public.
2. That any adjustments of said pipeline required for any State Farm to Market Road or any other improved road would be at 100 per cent cost to the applicant.
3. That all the rights, privileges and right-of-ways will be vested in said Applicant and its successors and assigns, without further grant or procedure.
4. Fees may or may not apply. If fees apply, fees need to accompany the application.
5. Notice of all applications will be sent to the Upper Trinity Groundwater Conservation District.

Source of the water:

Full Name and Address of Property Owner: _____

Well Site Physical Address: _____ UTGCD ID#: _____

Type of Water Used:

Surface Water	_____	Percentage
Ground Water	_____	Percentage
Both	_____	Percentage

GPS Coordinates: Latitude _____ Longitude _____

5334

Meter Serial Number: _____

Beginning Meter Reading (as displayed on meter): _____

Ending Meter Reading (as displayed on meter): _____

Location of the use of the water: _____ County: _____

Will any of this water be transported for use outside of the District (Montague, Parker, Wise, and Hood Counties)? Yes No

If yes, explain how the water was measured and include amount transported. _____

AFFIRMATION

I HEREBY SWEAR OR AFFIRM THAT THE INFORMATION INCLUDED IN THIS REPORT IS TRUE AND CORRECT TO THE BEST OF MY KNOWLEDGE.

DATE July 5, 2013

SIGNATURE *Beverly Davis*

MONTAGUE COUNTY, TEXAS
 TITUS COUNTY SCHOOL LAND SURVEY; A-730

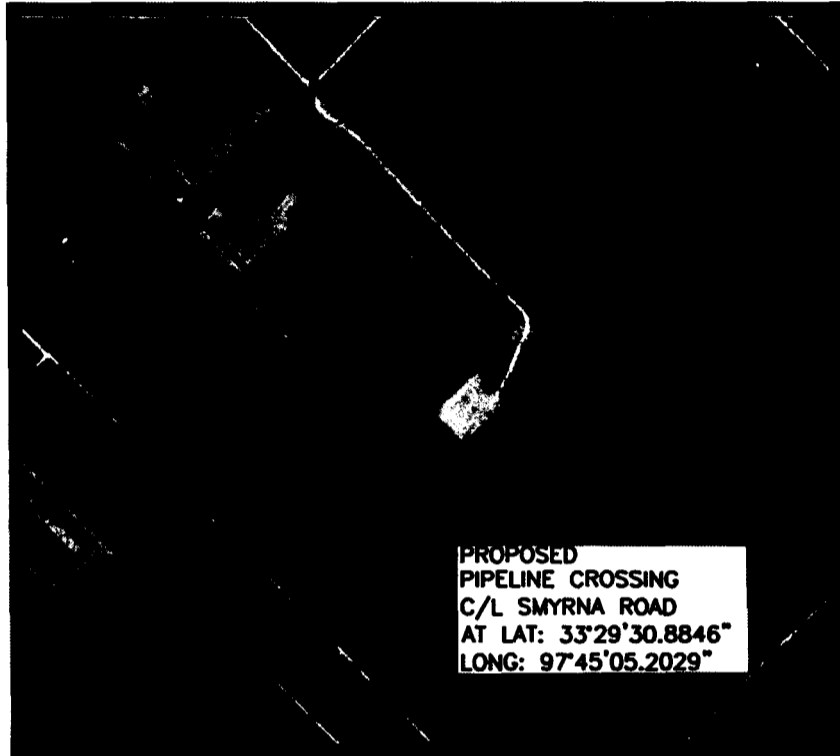

LOCATION MAP
 N.T.S.



TRWA, INC. | **TEXAS RIGHT OF WAY ASSOCIATES**
925 UNIVERSITY DRIVE FORT WORTH, TEXAS 76107 817-361-8839 | **MAPPING DIVISION**
LICENSE NO. 1012880 COPYRIGHT © 2012

PROPOSED PIPELINE LOCATION
 PIONEER NATURAL RESOURCES USA, INC.
 CROSSING COUNTY ROAD
SMYRNA ROAD
 TITUS COUNTY SCHOOL LAND SURVEY, A-730

DRAWN BY: BL/JNR	DATE: 06/28/13
CHECKED BY: E.S.H.	DATE: 06/28/13
SCALE: N.T.S.	PAGE: 1 OF 1

SML31 12.0_
 SMYRNA RD

MONTAGUE COUNTY,

TEXAS

TEMPORARY (FOUR WEEK ONLY) PERMIT AND RIGHT-OF-WAY TO CONSTRUCT 10" ALUMINUM FRAC LINE

STATE OF TEXAS	X	EOG RESOURCES, INC.
	X	
COUNTY OF MONTAGUE	X	

Now, on this the 22ND day of JULY, 2013, at a Regular Term and Session of the Commissioner Court of Montague County, Texas, can on to be considered the application of for a permit and right-of-way to lay, construct, maintain, and operate a TEMPORARY 10" ALUMINUM FRAC LINE , along, over, and across or under the County Right-of-way, of ALLEN ROAD, PCT. #1, the County of Montague, State of Texas, and the court having considered such application and is here referred to and made a part hereof, and having determined that the permit and right-of-way for such TEMPORARY 10" ALUMINUM FRAC LINE should be granted, it is accordingly ordered by the Court:

1. That the County of Montague, State of Texas, does hereby grant the right, privilege and right-of-way to EOG RESOURCES, INC., to lay, construct, maintain, and operate a TEMPORARY 10" ALUMINUM FRAC LINE , along, over, across, beside or under the County Right-a-way of ALLEN ROAD, PCT. #1, the County of Montague, State of Texas as described as a four week permit only.
2. That such TEMPORARY 10" ALUMINUM FRAC LINE shall be maintained as not to interfere with the use and occupancy of such roads by public.
3. That any adjustments of said TEMPORARY 10" ALUMINUM FRAC LINE , required for any County Right-of-way or any other improved County Road would be at 100 per cent cost to EOG RESOURCES, INC.
4. That all the rights, privileges and right-of-way herein above mentioned are by this order duly vested in said EOG RESOURCES, INC., its successors and assigns, without further grant or procedure.
5. That Montague County DOES NOT ALLOW any above ground lines to be laid on or beside roadways that are used to transfer Oil, Gas, or Salt Water Products.

Tommie Sappington

Tommie Sappington, Montague Co. Judge

STATE OF TEXAS	X	EOG RESOURCES, INC.
	X	
COUNTY OF MONTAGUE	X	

Before me, the undersigned authority, on this day personally appeared TOMMIE SAPPINGTON, known to me to be the person whose name is subscribed to the foregoing instrument and acknowledged to me that he executed the same for the purposes and consideration therein expressed and in the capacity therein stated.

Given under my hand and seal of office this 22ND day of JULY, 2013.

My commission expires:

Valerie Stout

Notary Public in and for Montague County, Texas.

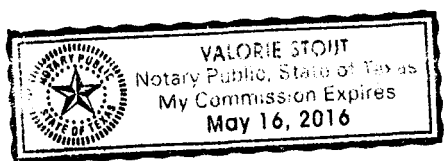

MONTAGUE COUNTY
APPLICATION FOR A PERMIT AND RIGHT-OF-WAY

DATE: 07/5/13

NAME: EOG RESOURCES, INC.

ADDRESS: 1451 W BUSINESS 380 COMP #3 DECATUR, TEXAS 76234

CONTACT PERSON: HERMAN WILSON TELEPHONE NO. 940-867-3252

ROAD NAME: ALLEN ROAD COMMISSIONER PCT. 1

GPS Coordinates: Latitude _____ Longitude _____

TEMPORARY PERMANENT PLAT

ATTACHED

This document is an application for a permit and right-of-way. Please give a descriptive explanation of the work to be done:

10" ALUMINUM FRAC LINES
ALLEN ROAD APPROX 3800 FEET

GPS Coordinates: Latitude _____ Longitude _____

If your application for the permit and right-of-way is approved by the Montague County Commissioners Court and an Order to grant the permit and right-of-way for such pipeline should be granted, the following is understood:

1. That such pipeline shall be so buried, cased, covered, constructed and maintained as not to interfere with the use and occupancy of such roads by public.
2. That any adjustments of said pipeline required for any State Farm to Market Road or any other improved road would be at 100 per cent cost to the applicant.
3. That all the rights, privileges and right-of-ways will be vested in said Applicant and its successors and assigns, without further grant or procedure.
4. Fees may or may not apply. If fees apply, fees need to accompany the application.
5. Notice of all applications will be sent to the Upper Trinity Groundwater Conservation District.

Source of the water:

Full Name and Address of Property Owner: EOG Resources, Inc.

Well Site Physical Address: _____ UTGCD ID: 179/180

Type of Water Used:

Surface Water	_____	Percentage
Ground Water	<input checked="" type="checkbox"/>	Percentage
Both	_____	Percentage

GPS Coordinates: Latitude _____ N/A _____ Longitude _____ N/A _____

Meter Serial Number: _____ N/A _____

24565

Beginning Meter Reading (as displayed on meter): N/A

Ending Meter Reading (as displayed on meter): N/A

Location of the use of the water N/A County: N/A

Will any of this water be transported for use outside of the District (Montague, Parker, Wise, and Hood Counties)?
Yes No N/A

If yes, explain how the water was measured and include amount transported.

AFFIRMATION

I HEREBY SWEAR OR AFFIRM THAT THE INFORMATION INCLUDED IN THIS REPORT IS TRUE AND CORRECT TO THE BEST OF MY KNOWLEDGE.

DATE 7/5/13

SIGNATURE *[Handwritten Signature]*

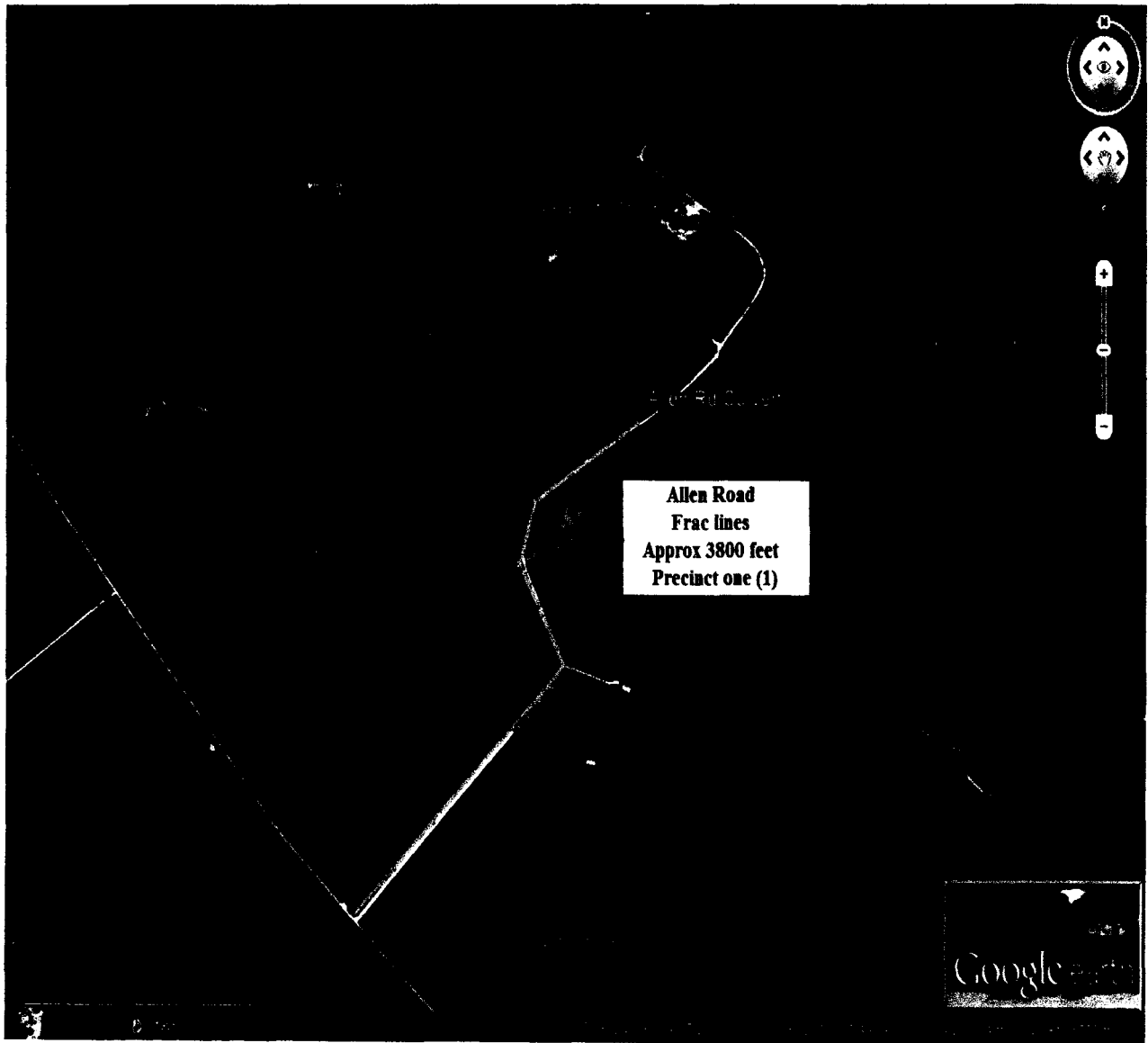

ORDER GRANTING PERMIT AND RIGHT-OF-WAY
TO CONSTRUCT GAS PIPELINE

STATE OF TEXAS X EOG RESOURCES, INC.
X
COUNTY OF MONTAGUE X

Now, on this the 22nd day JULY, 2013, at a regular Term and Session of the Commissioner's Court of Montague County, Texas, can on to be considered the application of EOG RESOURCES, INC. for a permit and right-of-way to lay, construct, maintain, operate a ROAD CROSSING on EAST R.C. ROAD located in Precinct #2 of the County of Montague, State of Texas, and the court having considered such application and is here referred to and made a part hereof, and having determined that the permit and right-of-way for such pipeline should be granted, it is accordingly ordered by the Court:

1. That the County of Montague, State of Texas, does hereby grant the right, privilege and right-of-way to EOG RESOURCES, INC., to lay, construct, maintain, operate a pipeline along, over, across or under the public roads, streets, alleyways of the County of Montague, State of Texas.
2. That such pipeline shall be so buried, cased, covered, constructed and maintained as not to interfere with the use and occupancy of such roads by public. Said pipeline shall be buried 3 feet below bar ditches.
3. That any adjustments of said pipeline required for any State Farm to Market Road or any other improved road would be at 100 per cent cost to EOG RESOURCES, INC.,
4. That all the rights, privileges and right-of-way herein above mentioned are by this order duly vested in said EOG RESOURCES, INC., its successors and assigns, without further grant or procedure.



Tommie Sappington, County Judge

STATE OF TEXAS X EOG RESOURCES, INC.
X
COUNTY OF MONTAGUE X

Before me, the undersigned authority, on this personally appeared Tommie Sappington, known to me to be the person whose name is subscribed to the foregoing instrument and acknowledged to me that he executed the same for the purposes and consideration therein expressed and in the capacity therein stated.

Given under my hand and seal of office this 22nd day of JULY, 2013.

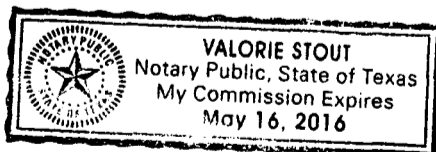
My commission expires:



Valorie Stout
Notary Public in and for
Montague County, Texas

MONTAGUE COUNTY
APPLICATION FOR A PERMIT AND RIGHT-OF-WAY

DATE: July 8, 2013

NAME: EOG Resources, Inc.

ADDRESS: 1451 W. Bus. 380, Comp.11/Bld. 1, Decatur, Tx. 76234

CONTACT PERSON: Clayton Henderson TELEPHONE NO. 817-598-8628

ROAD NAME: East R.C. Road COMMISSIONER PCT. 2

GPS Coordinates: Latitude N 33 38' 28.59'' Longitude W 97 52' 28.13''
(GPS Coordinates for Road Crossing)

 TEMPORARY PERMANENT PLAT ATTACHED

This document is an application for a permit and right-of-way. Please give a descriptive explanation of the work to be done: **EOG Resources, Inc. requests to bore under East R.C. Rd. approximately 3,200 feet North of Bates Road with a twenty (20) inch steel casing for an eight (8) inch poly gas line, and an eight (8) inch produced water line.**

If your application for the permit and right-of-way is approved by the Montague County Commissioners Court and an Order to grant the permit and right-of-way for such pipeline should be granted, the following is understood:

1. That such pipeline shall be so buried, cased, covered, constructed and maintained as not to interfere with the use and occupancy of such roads by public.
2. That any adjustments of said pipeline required for any State Farm to Market Road or any other improved road would be at 100 per cent cost to the applicant.
3. That all the rights, privileges and right-of-ways will be vested in said Applicant and its successors and assigns, without further grant or procedure.
4. Fees may or may not apply. If fees apply, fees need to accompany the application.
5. Notice of all applications will be sent to the Upper Trinity Groundwater Conservation District.

Source of the water: N/A Produced Water Only

Full Name and Address of Property Owner: N/A

Well Site Physical Address: N/A UTGCD ID#: N/A

Type of Water Used: N/A

Surface Water	_____	Percentage
Ground Water	_____	Percentage
Both	_____	Percentage

GPS Coordinates: Latitude N/A Longitude N/A

Meter Serial Number: N/A

2642

Beginning Meter Reading (as displayed on meter): N/A

Ending Meter Reading (as displayed on meter): N/A

Location of the use of the water: N/A County: N/A

Will any of this water be transported for use outside of the District (Montague, Parker, Wise, and Hood Counties)? No

If yes, explain how the water was measured and include amount transported. N/A

AFFIRMATION

I HEREBY SWEAR OR AFFIRM THAT THE INFORMATION INCLUDED IN THIS REPORT IS TRUE AND CORRECT TO THE BEST OF MY KNOWLEDGE.

DATE July 12, 2013

SIGNATURE 



LIMESTONE COUNTY
SCHOOL LAND
A-421

BARNEY C. JACKSON AND
NANCY JACKSON
VOLUME 527, PAGE 193
CALLED 80 ACRES

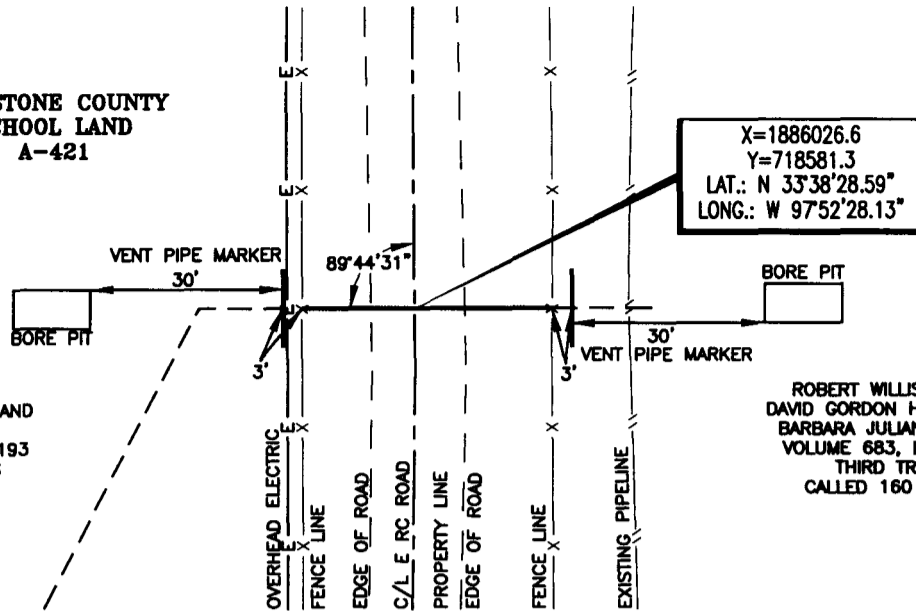

ROBERT WILLIS HEARD
DAVID GORDON HEARD, AND
BARBARA JULIANN HEARD
VOLUME 683, PAGE 685
THIRD TRACT
CALLED 160 ACRES

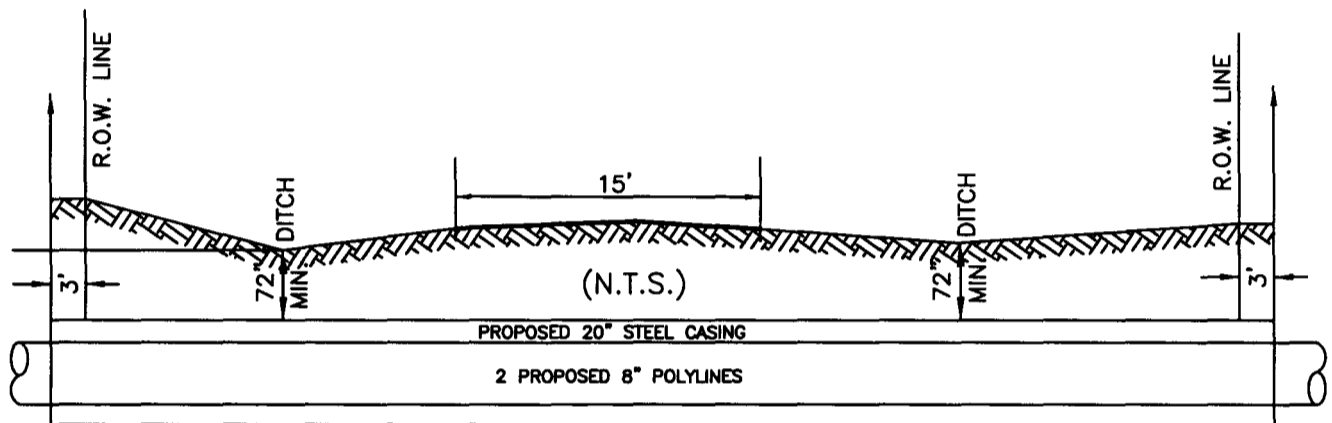

PLAN AND PROFILE OF
A 20" STEEL CASING
2 8" POLYLINES

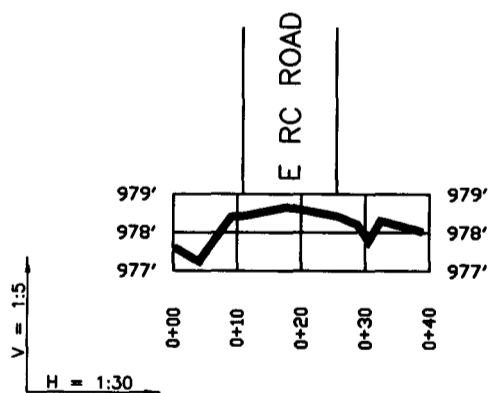

Geog resources, inc.

TOPOGRAPHIC

SURVEYING • MAPPING • GIS • GPS
1400 EVERMAN PARKWAY, Ste. 187 • FT. WORTH, TEXAS 76140
TELEPHONE: (817) 744-7512 • FAX (817) 744-7548
WWW.TOPOGRAPHIC.COM

BOWIE EAST GGS BLAKE LATERAL
PROPOSED PIPELINE CROSSING
E RC ROAD +/- 6,075 FEET
SOUTHEAST OF US. HWY. 81
MONTAGUE COUNTY, TEXAS
NOT TO SCALE = N.T.S.

SCALE	DRAWN BY	DATE
1" = 30'	C.A.R.	7-12-13

ORDER GRANTING PERMIT AND RIGHT-OF-WAY
TO CONSTRUCT GAS PIPELINE

STATE OF TEXAS X EOG RESOURCES, INC.
X
COUNTY OF MONTAGUE X

Now, on this the 22nd day JULY, 2013, at a regular Term and Session of the Commissioner's Court of Montague County, Texas, can on to be considered the application of EOG RESOURCES, INC. for a permit and right-of-way to lay, construct, maintain, operate a ROAD CROSSING on PAYNE ROAD located in Precinct #4 of the County of Montague, State of Texas, and the court having considered such application and is here referred to and made a part hereof, and having determined that the permit and right-of-way for such pipeline should be granted, it is accordingly ordered by the Court:

1. That the County of Montague, State of Texas, does hereby grant the right, privilege and right-of-way to EOG RESOURCES, INC., to lay, construct, maintain, operate a pipeline along, over, across or under the public roads, streets, alleyways of the County of Montague, State of Texas.
2. That such pipeline shall be so buried, cased, covered, constructed and maintained as not to interfere with the use and occupancy of such roads by public. Said pipeline shall be buried 3 feet below bar ditches.
3. That any adjustments of said pipeline required for any State Farm to Market Road or any other improved road would be at 100 per cent cost to EOG RESOURCES, INC.,
4. That all the rights, privileges and right-of-way herein above mentioned are by this order duly vested in said EOG RESOURCES, INC., its successors and assigns, without further grant or procedure.

Tommie Sappington

Tommie Sappington, County Judge

STATE OF TEXAS X EOG RESOURCES, INC.
X
COUNTY OF MONTAGUE X

Before me, the undersigned authority, on this personally appeared Tommie Sappington, known to me to be the person whose name is subscribed to the foregoing instrument and acknowledged to me that he executed the same for the purposes and consideration therein expressed and in the capacity therein stated.

Given under my hand and seal of office this 22nd day of JULY, 2013.

My commission expires:

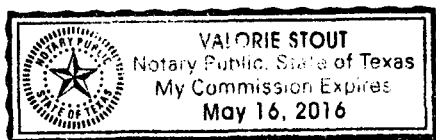

Valorie Stout

Notary Public in and for
Montague County, Texas

✓

MONTAGUE COUNTY
APPLICATION FOR A PERMIT AND RIGHT-OF-WAY

DATE: July 12th, 2013

NAME: EOG Resources, Inc.

ADDRESS: 1451 W. Bus 380 Comp. 4/Bld. 2 Decatur, TX 76234

CONTACT PERSON: Wesley H. Moss TELEPHONE NO. (940) 577-0264

ROAD NAME: Payne Rd. COMMISSIONER PCT. 1 2 3 4

GPS Coordinates: Latitude 33°41'28.49" Longitude 97°32'49.23
(GPS Coordinates for Road Crossing)

 TEMPORARY X PERMANENT PLAT ATTACHED

This document is an application for a permit and right-of-way. Please give a descriptive explanation of the work to be done:
EOG Resources, Inc. proposes to bore Payne Rd. approximately
1,750 Ft. SE of HWY 59 with a 6" DR7-Poly Gas Line
cased within a 10" steel casing. All work shall be done
from outside the county ROW.

If your application for the permit and right-of-way is approved by the Montague County Commissioners Court and an Order to grant the permit and right-of-way for such pipeline should be granted, the following is understood:

1. That such pipeline shall be so buried, cased, covered, constructed and maintained as not to interfere with the use and occupancy of such roads by public.
2. That any adjustments of said pipeline required for any State Farm to Market Road or any other improved road would be at 100 per cent cost to the applicant.
3. That all the rights, privileges and right-of-ways will be vested in said Applicant and its successors and assigns, without further grant or procedure.
4. Fees may or may not apply. If fees apply, fees need to accompany the application.
5. Notice of all applications will be sent to the Upper Trinity Groundwater Conservation District.

Source of the water:

Full Name and Address of Property Owner: NA

Well Site Physical Address: NA UTGCD ID#: NA

Type of Water Used:

Surface Water	<u>NA</u>	Percentage
Ground Water	<u>NA</u>	Percentage
Both	<u>NA</u>	Percentage

93805

GPS Coordinates: Latitude NA Longitude NA

Meter Serial Number: NA

Beginning Meter Reading (as displayed on meter): NA

Ending Meter Reading (as displayed on meter): NA

Location of the use of the water: NA County: _____

Will any of this water be transported for use outside of the District (Montague, Parker, Wise, and Hood Counties)? ~~Yes~~ ~~No~~

If yes, explain how the water was measured and include amount transported. NA

AFFIRMATION

I HEREBY SWEAR OR AFFIRM THAT THE INFORMATION INCLUDED IN THIS REPORT IS TRUE AND CORRECT TO THE BEST OF MY KNOWLEDGE.

DATE 7-12-13

SIGNATURE Wally W. Mann



SURFACE LOCATION
 X=1985701.1
 Y=736564.2
 LAT.: N 33°41'28.49"
 LONG.: W 97°32'49.23"

J. MILLER
 A-481

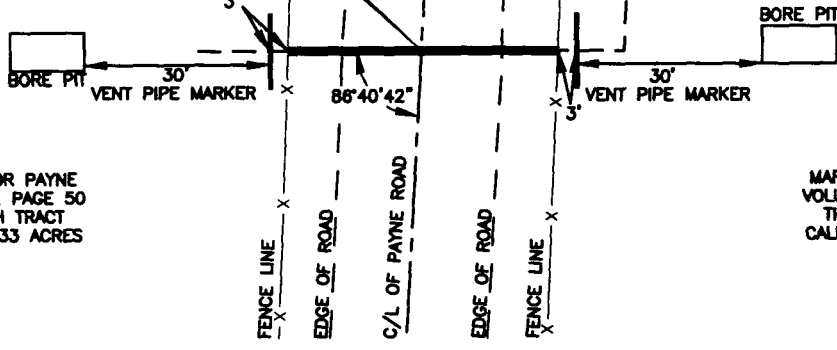

MARY MEADOR PAYNE
 VOLUME 574, PAGE 50
 THIRTEENTH TRACT
 CALLED 232.33 ACRES

MARY MEADOR PAYNE
 VOLUME 574, PAGE 50
 THIRTEENTH TRACT
 CALLED 232.33 ACRES

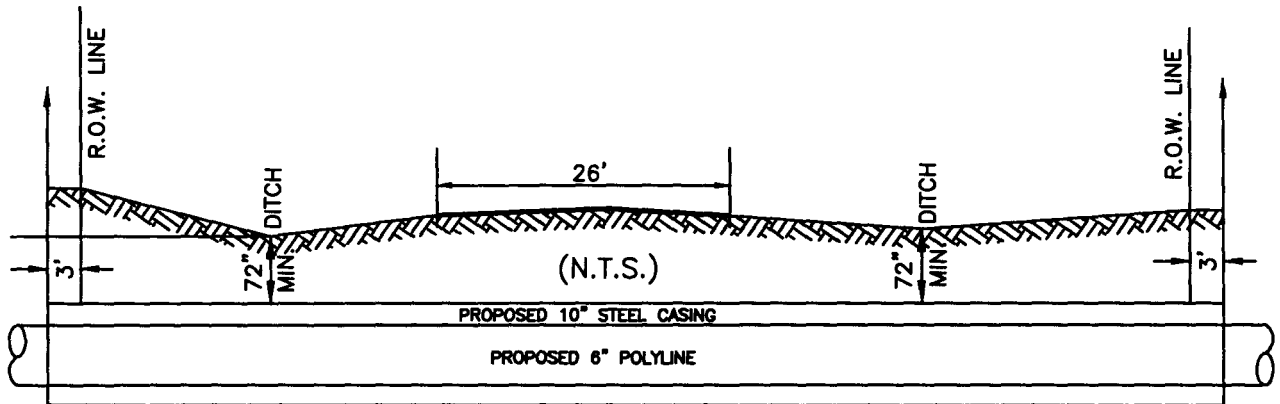

**PLAN AND PROFILE OF A 10" STEEL CASING
 6" POLYLINE**

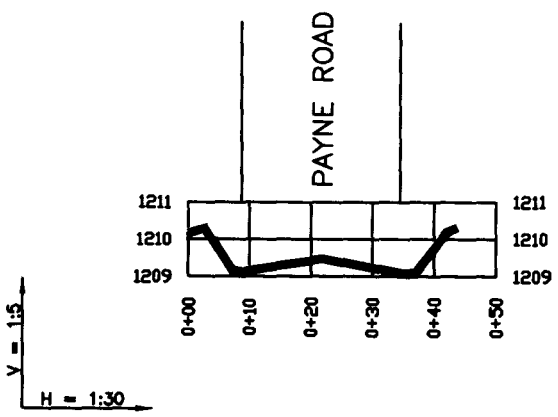

Geog resources, Inc.
TOPOGRAPHIC
 SURVEYING • MAPPING • GIS • GPS
 1400 EVERMAN PARKWAY, Ste. 187 • FT. WORTH, TEXAS 76140
 TELEPHONE: (817) 744-7512 • FAX (817) 744-7548
 WWW.TOPOGRAPHIC.COM

OSBORN GGS CAYCE A1H LATERAL
 PROPOSED PIPELINE CROSSING
 PAYNE ROAD +/- 1,750 FEET
 SOUTHEAST OF STATE HWY. 59
 MONTAGUE COUNTY, TEXAS
 NOT TO SCALE = N.T.S.

SCALE	DRAWN BY	DATE
1" = 30'	C.A.R.	07-10-13

S:\SURVEY\EDGE_PL\OSBORN_GGS_CAYCE_A1H_LATERAL\FINAL_PRODUCTS\RP_OSBORN_GGS_CAYCE_A1H_LATERAL_PAYNE_ROAD.DWG